

Assembly instructions

# MARBLE RUN Dragon

Mechanical model  
by iDventure

To access the digital version  
of the instructions use the  
QR-code or the link below.  
[www.idventure.de/dragon](http://www.idventure.de/dragon)





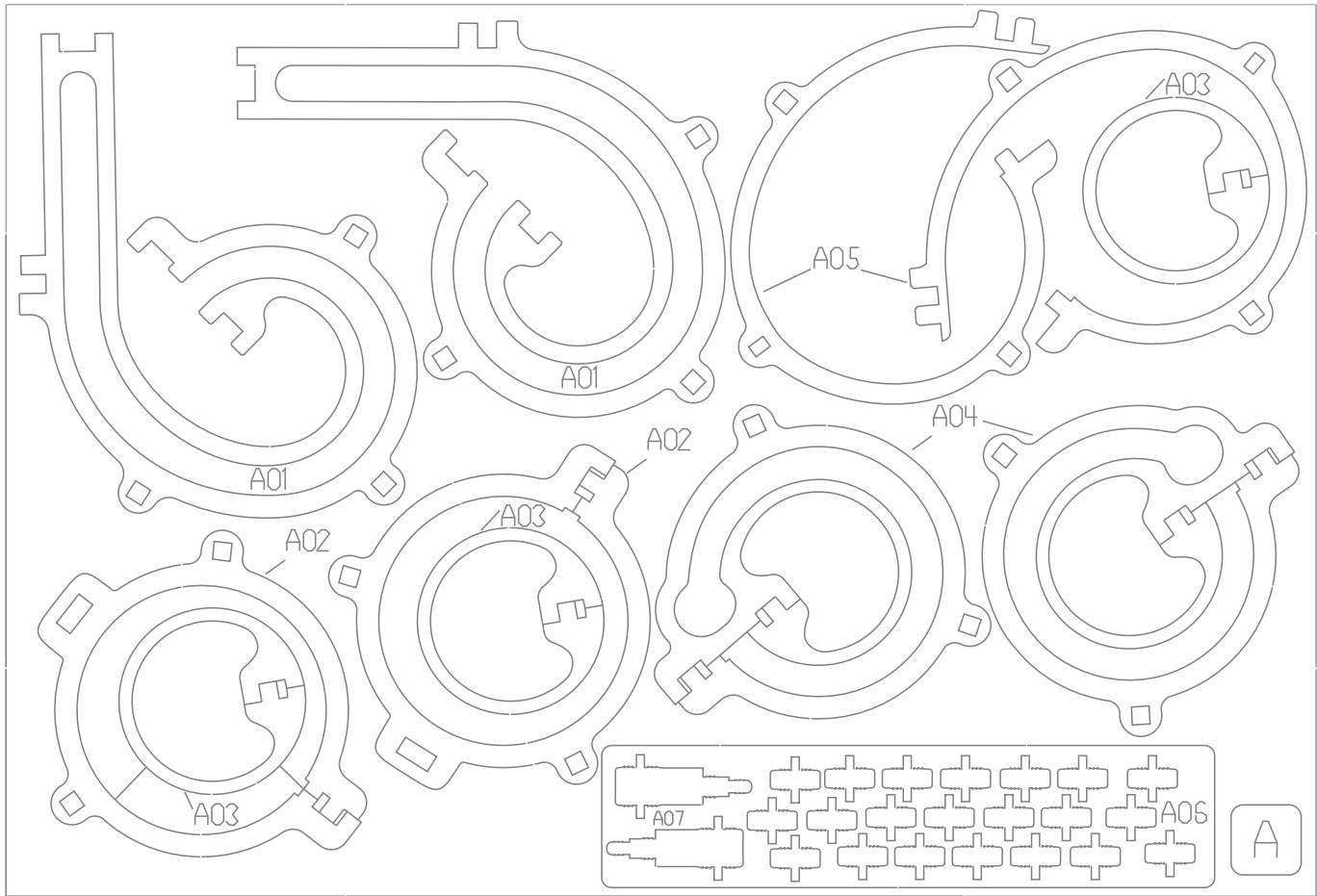

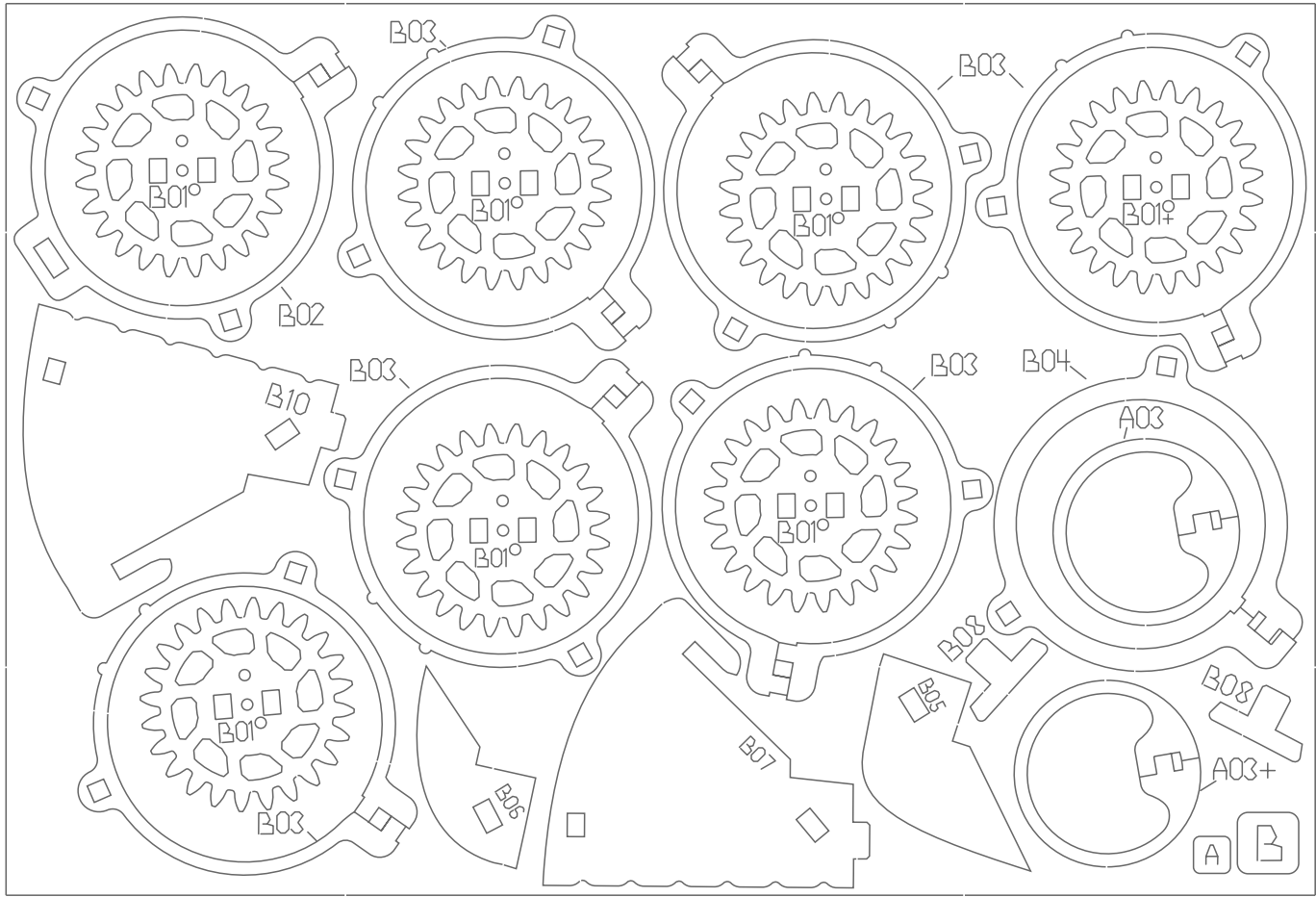

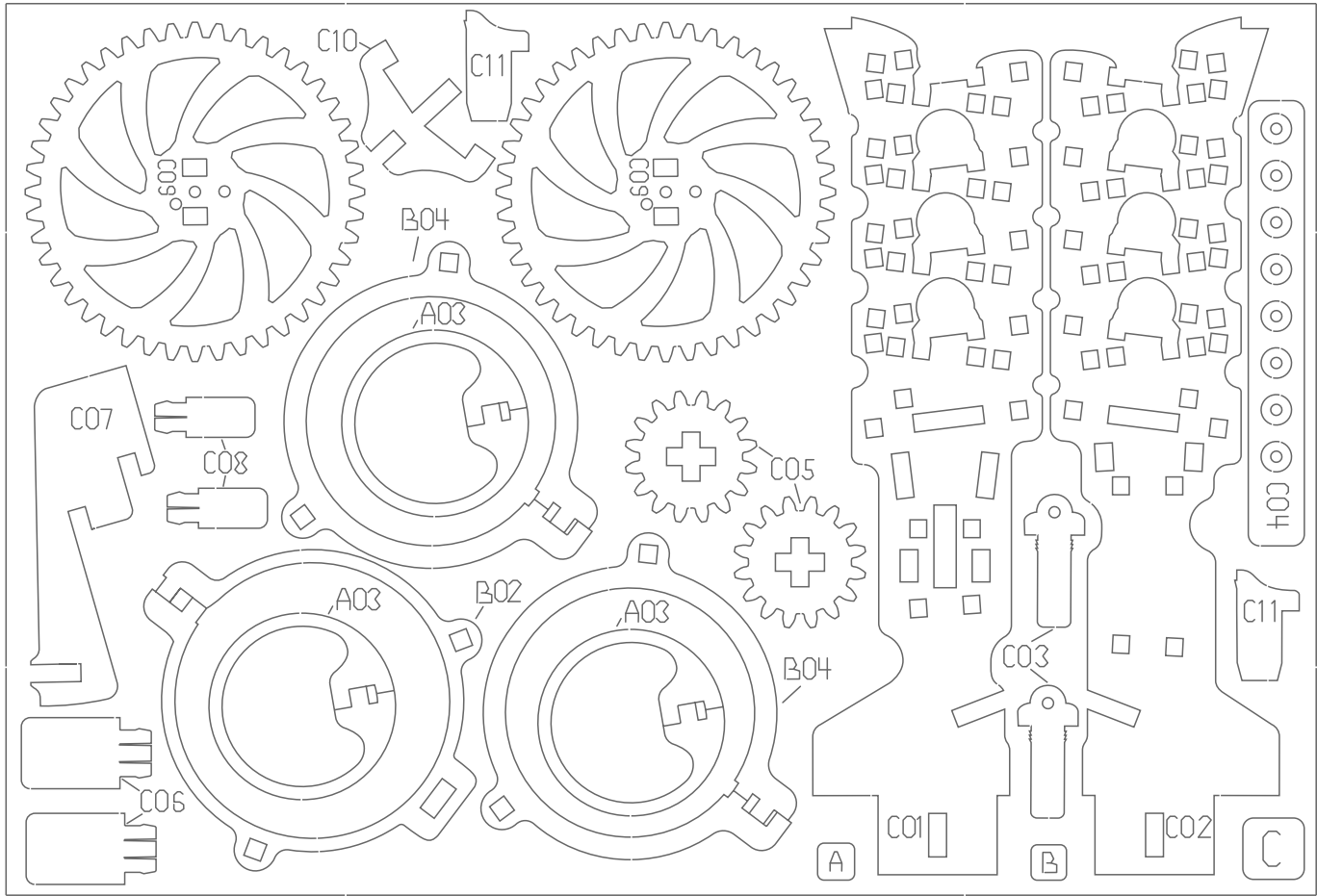

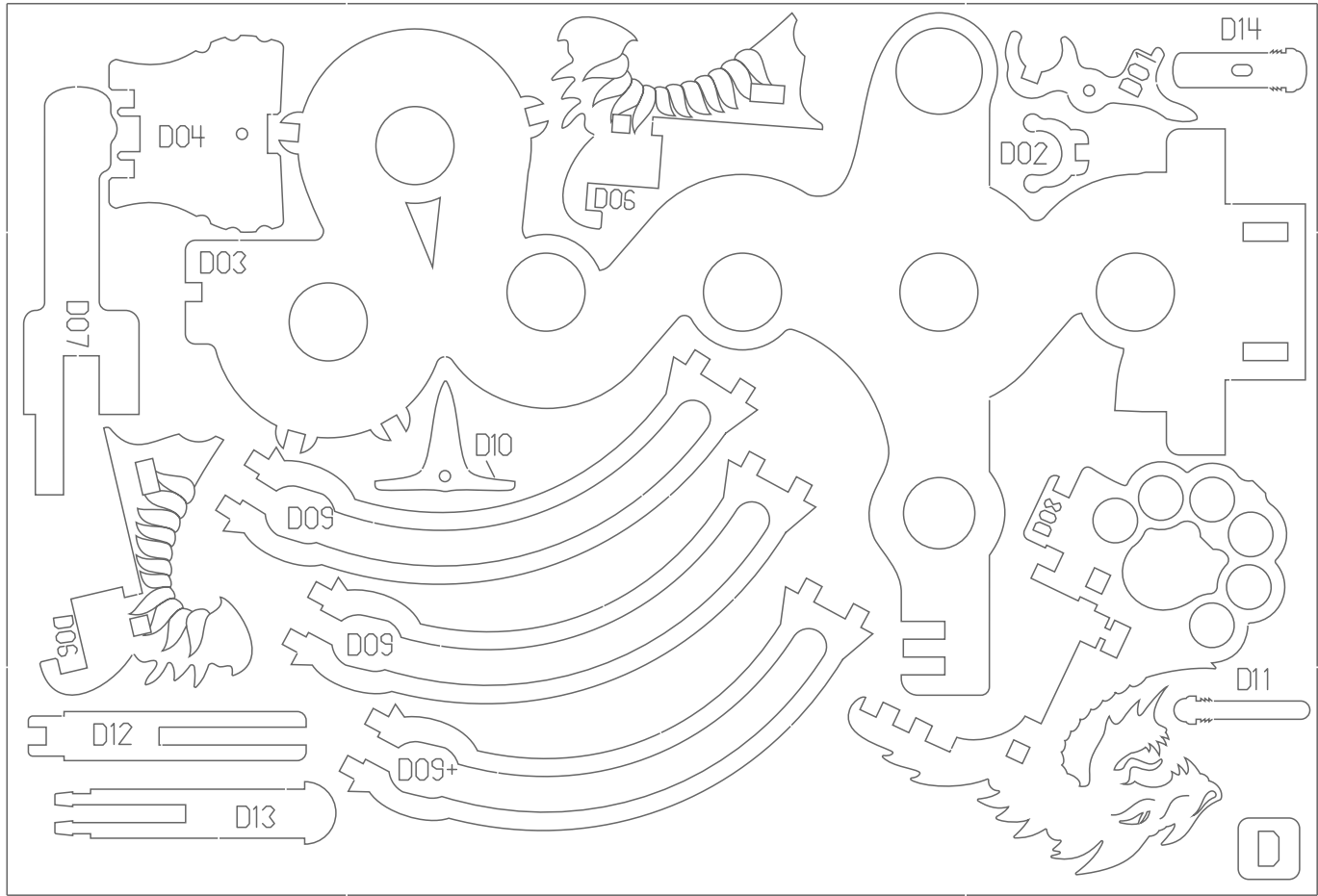

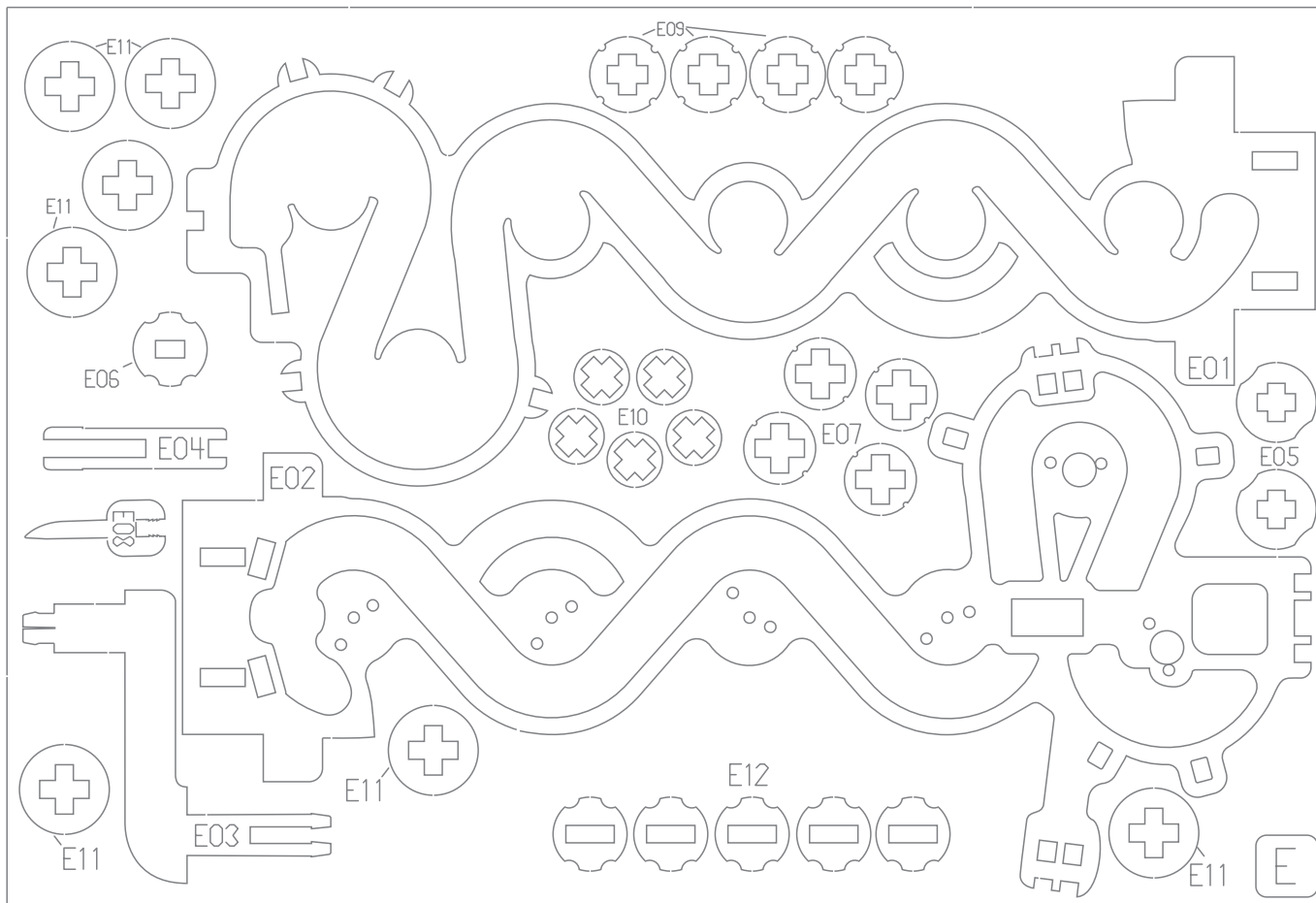

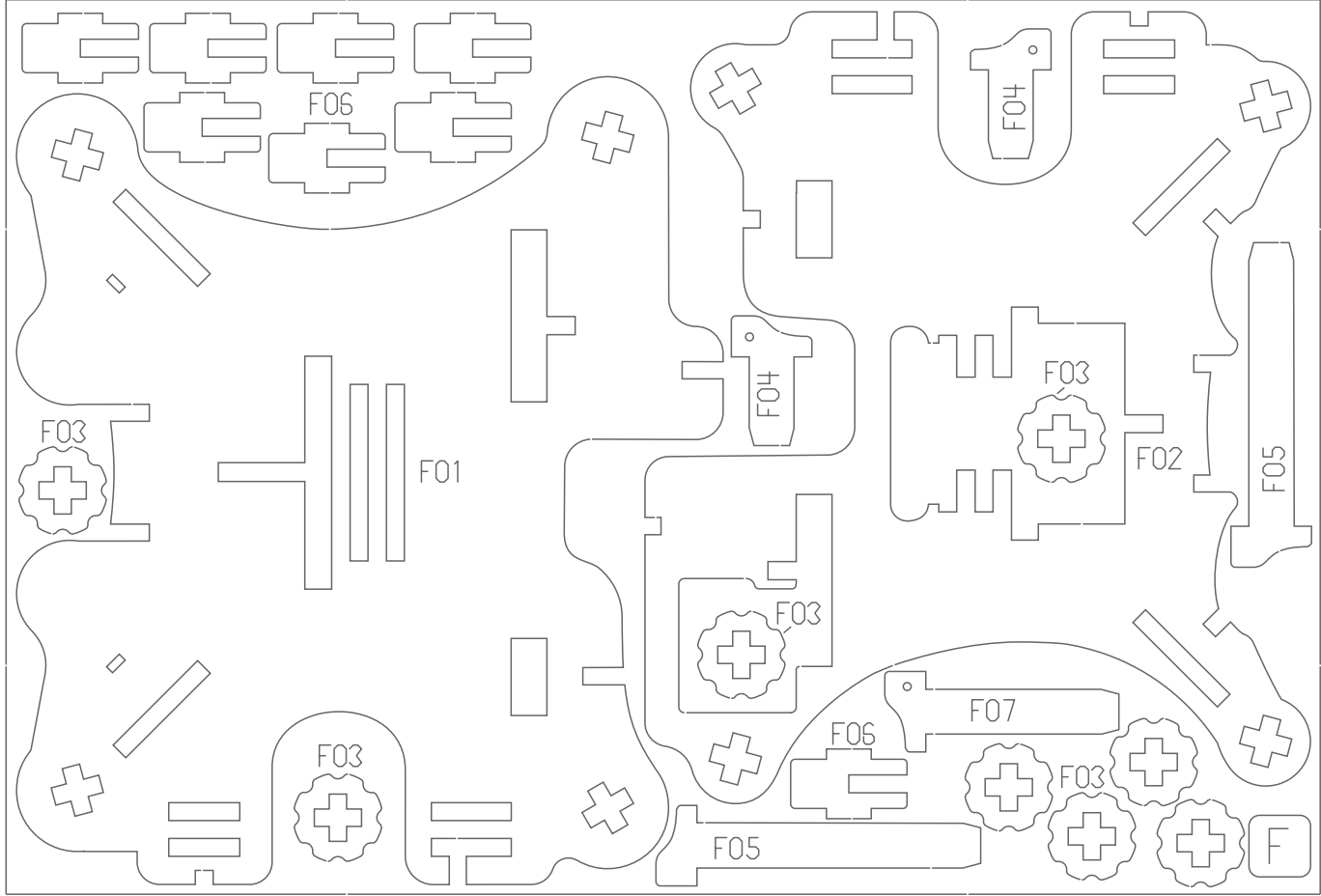



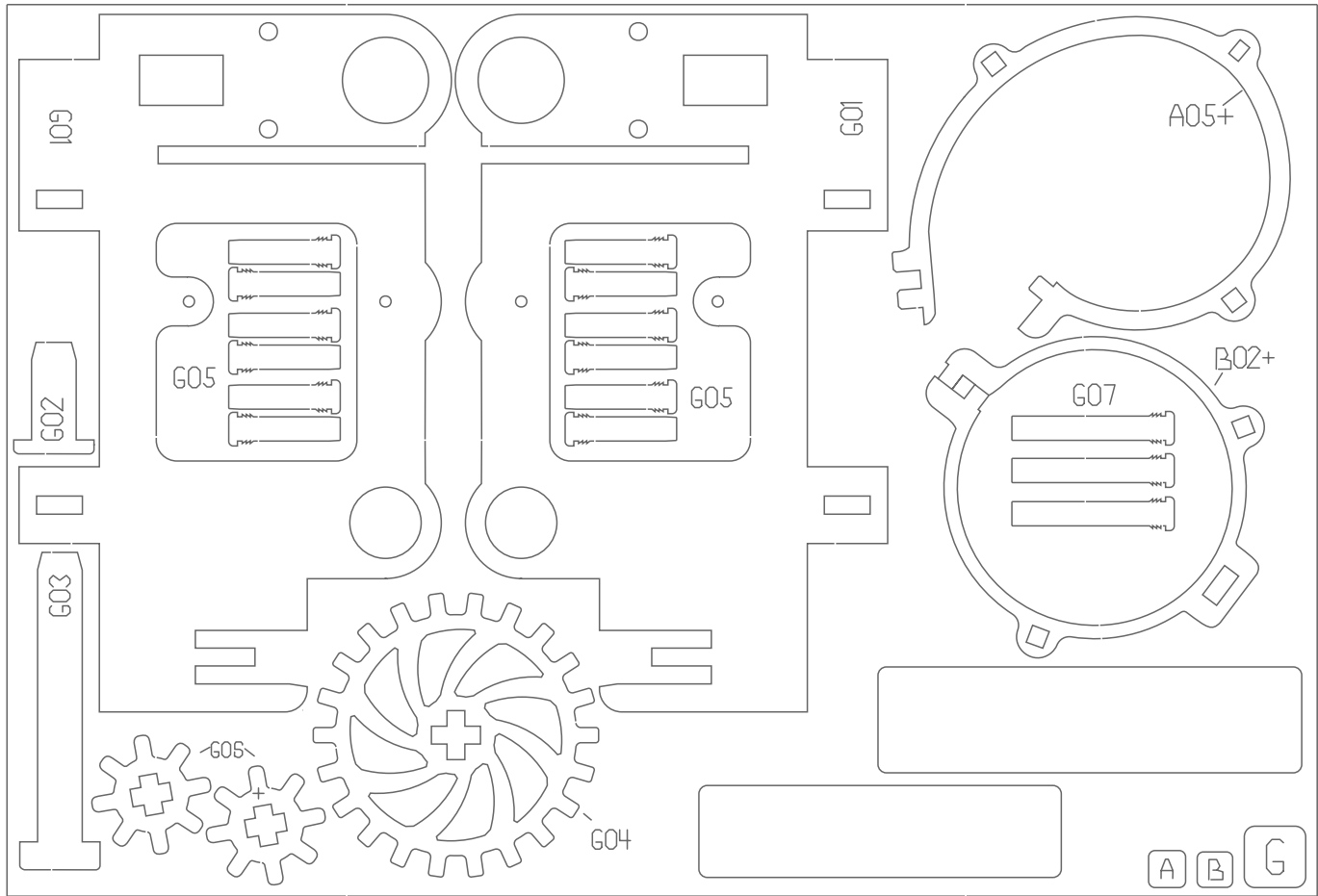

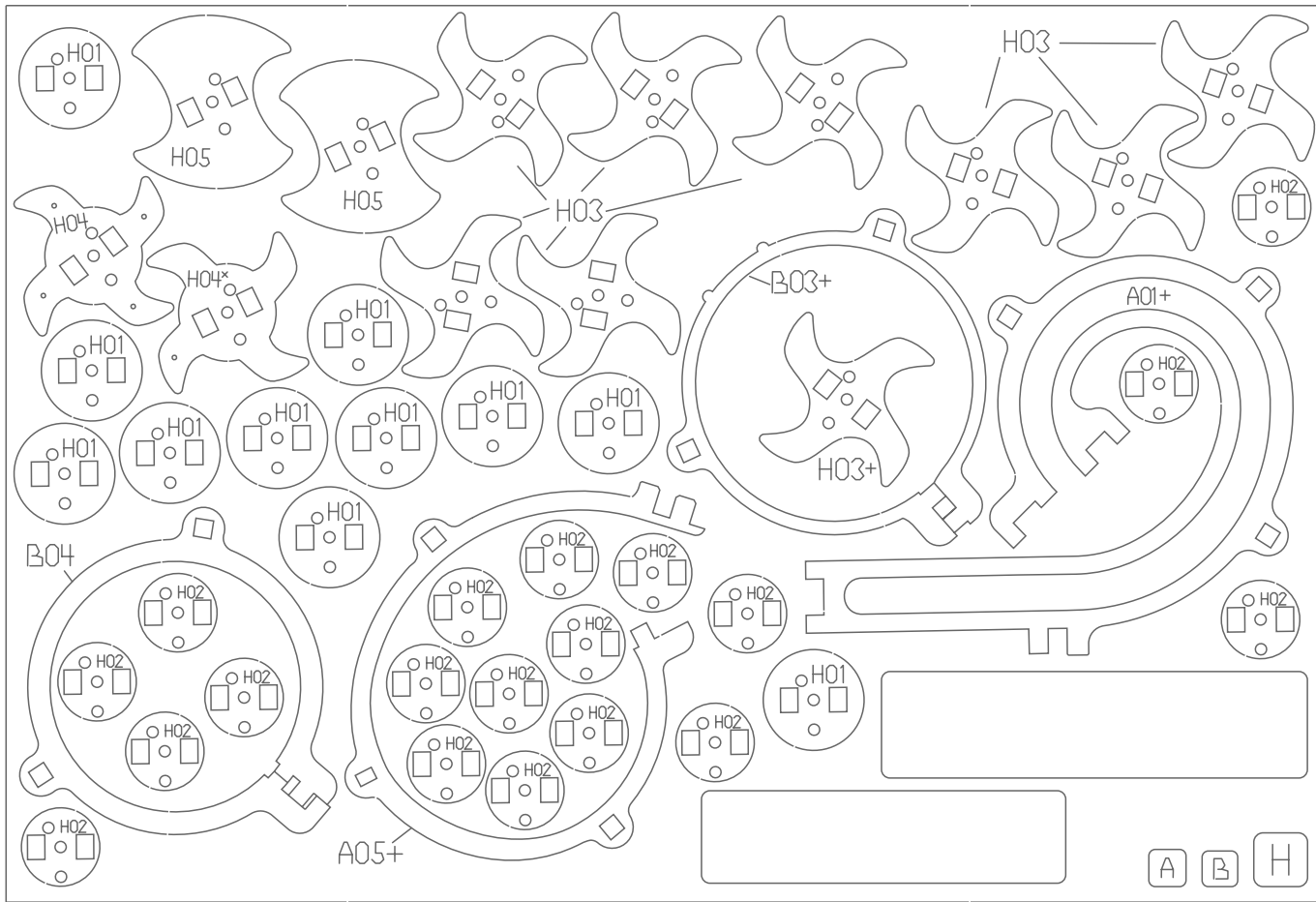

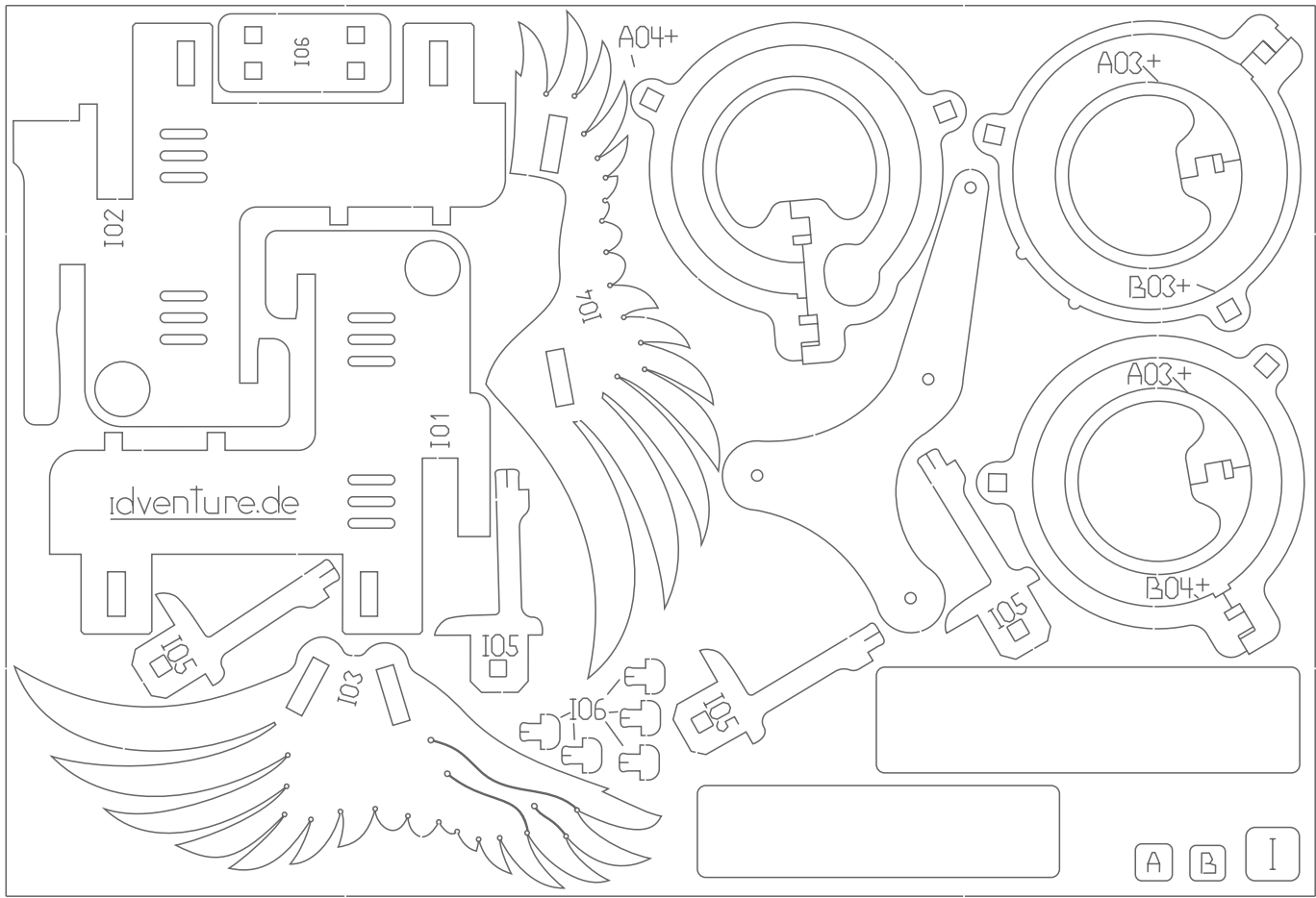

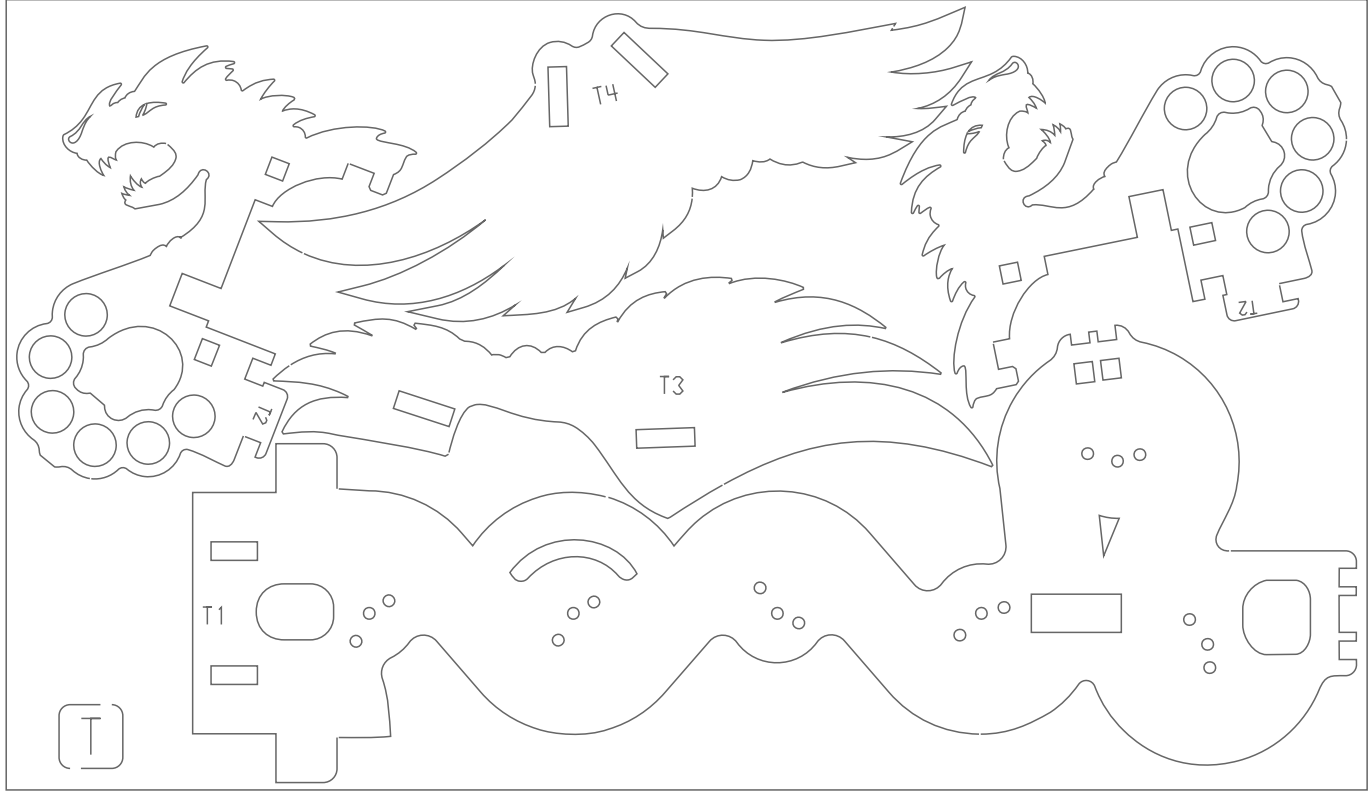



Index for a spare part



Direction of the action in this step



Insert as far as it will go



Fragile

Operate carefully. Very fragile detail



Warning



Wax with a candle

Use a regular paraffin candle to wax all rubbing **parts subjected to friction**. *In some places they can be front and back surfaces.*



Better way to assemble



Turn over



Cut the toothpicks



Item assembled

At this stage, the assembly of the part is completed



Remove the protective film before use

### Specification for non-wooden parts

Steel marbles	16 pcs
Plastic sleeves	30+ pcs
Toothpicks	20+ pcs

### Warning!



**Glue: it is recommended to use PVA glue or analogs for non-moving joints.**



**Toothpicks have a sharp tip.**



**Do not use a lighted candle.**

# Assembling the tracks

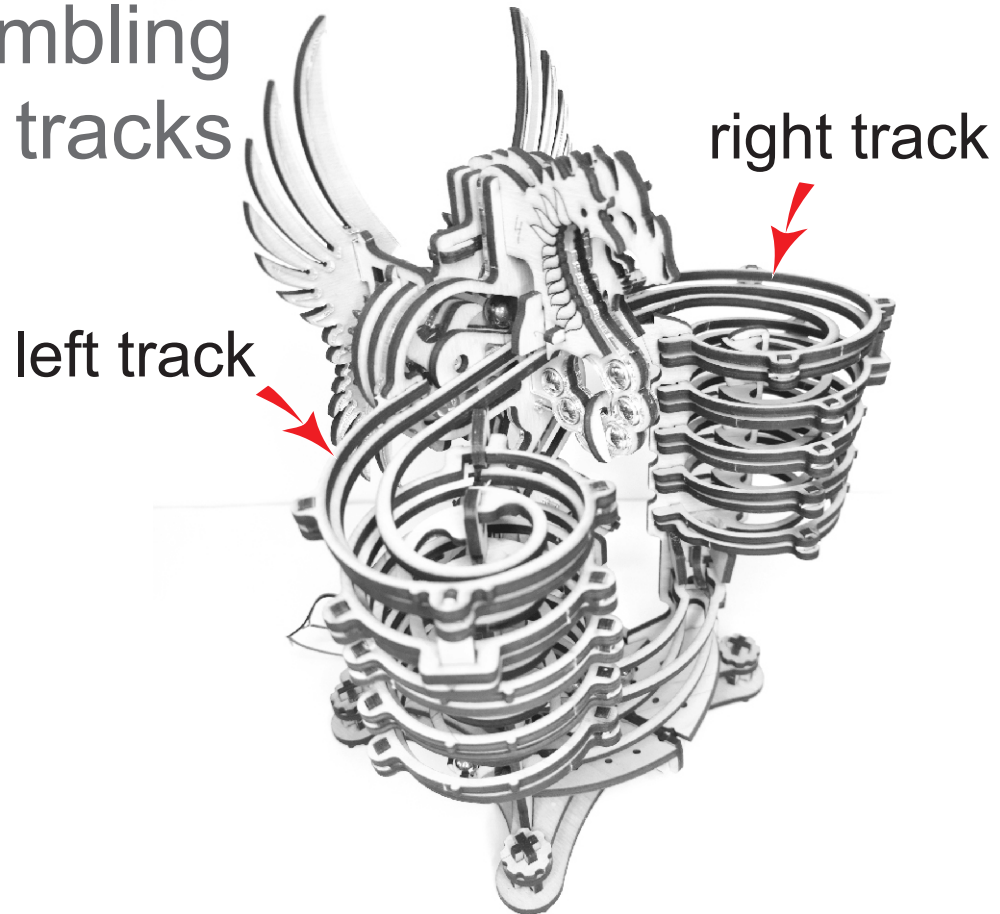

## Left track

- A01 - 1 pc.
- A02 - 1 pc.
- A03 - 3 pcs
- A04 - 1 pc.
- A05 - 1 pc.
- A06 - 10 pcs
- A07 - 1 pc.
- B02 - 1 pc.
- B03 - 3 pcs
- B04 - 2 pcs
- C02 - 1 pc.
- C08 - 2 pcs

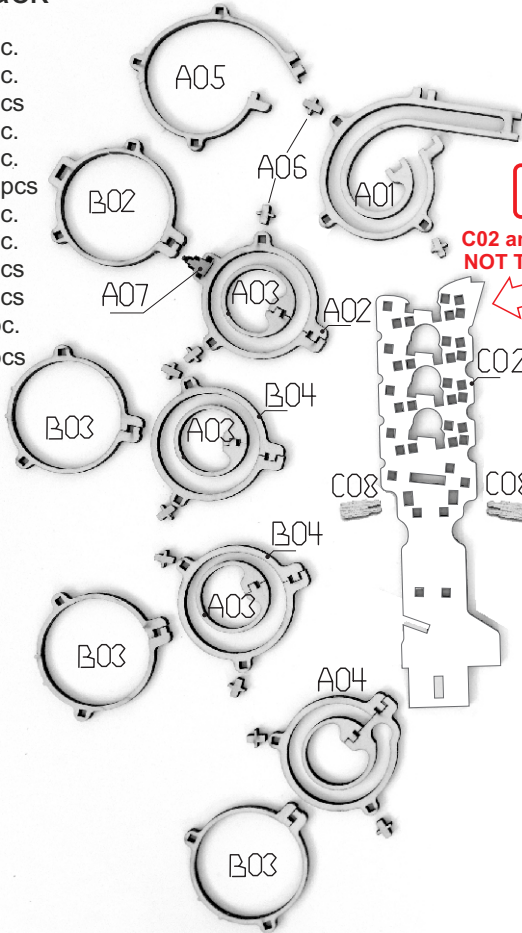

**!**  
**C02 and C01 are**  
**NOT THE SAME**

## Right track

- A01 - 1 pc.
- A02 - 1 pc.
- A03 - 3 pcs
- A04 - 1 pc.
- A05 - 1 pc.
- A06 - 10 pcs
- A07 - 1 pc.
- B02 - 1 pc.
- B03 - 3 pcs
- B04 - 2 pcs
- C01 - 1 pc.
- C03 - 2 pcs
- C04 - 2 pcs
- C06 - 2 pcs
- D01 - 1 pc.
- D02 - 1 pc.

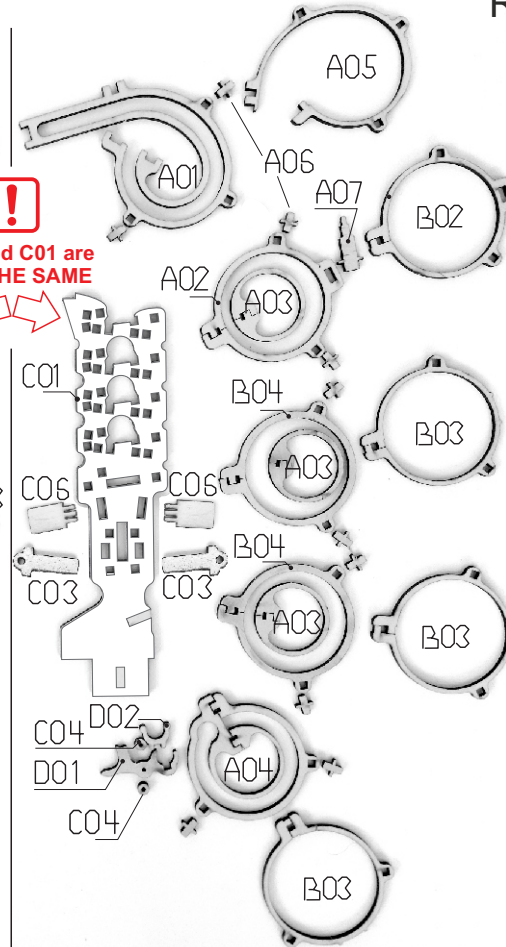

# Assembling the left track

Locate A06 (10 pcs)

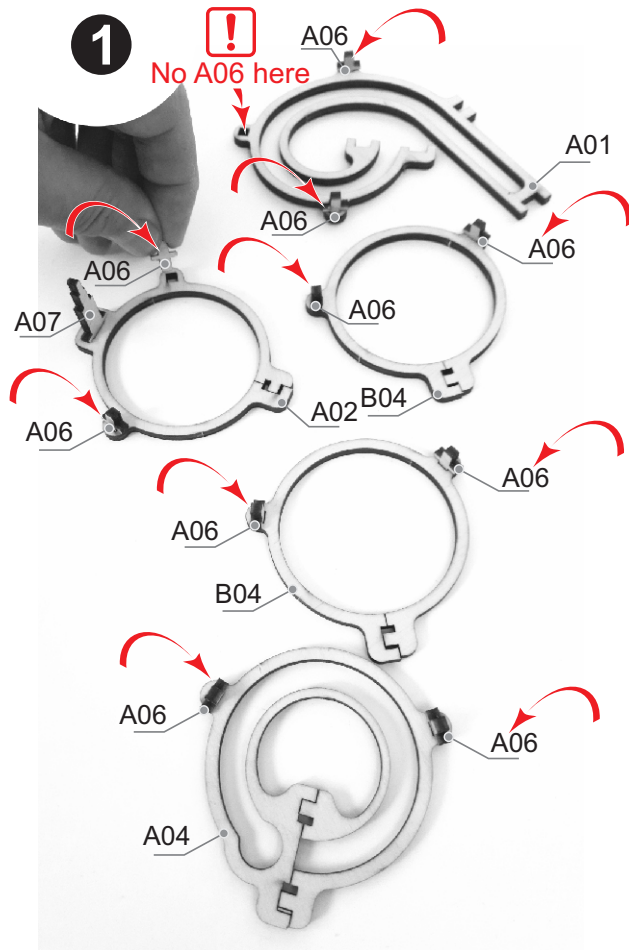

TIPS & TRICK

For safe installation:  
first, put A03 in parallel to C02

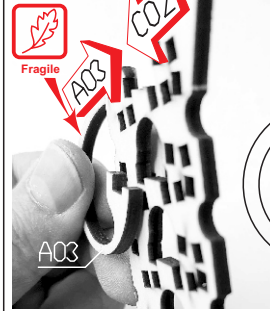

Then rotate counter-clockwise



Repeat the operation for all three A03



**2** Locate A03 (3 pcs)

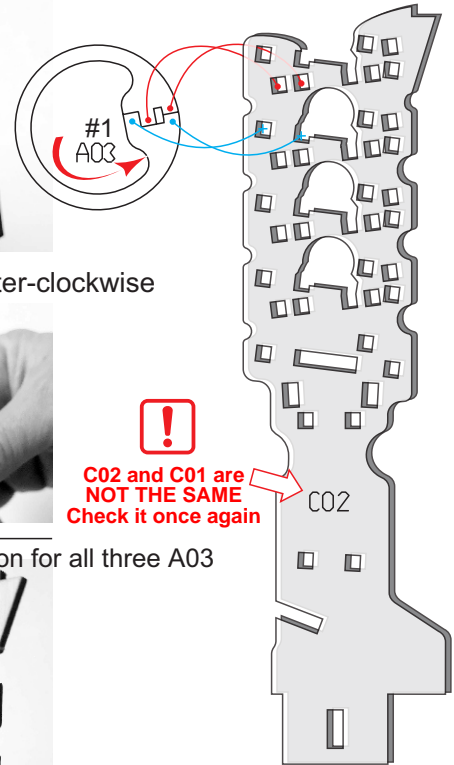



2.1

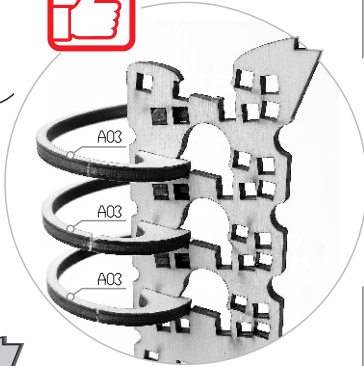
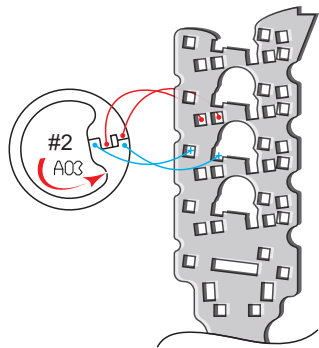

2.2

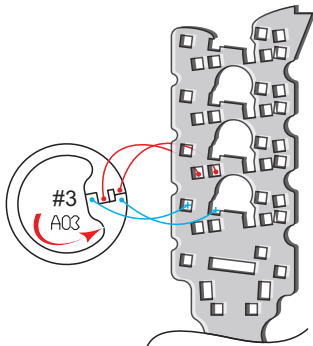

TIPS & TRICK

For safe installation: first, put A04 in **parallel** to C02



Fragile

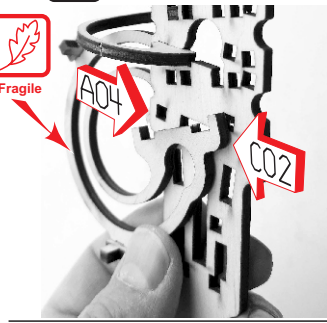

3

Locate A04 (1 pc.)

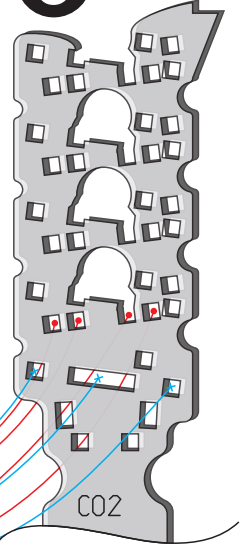
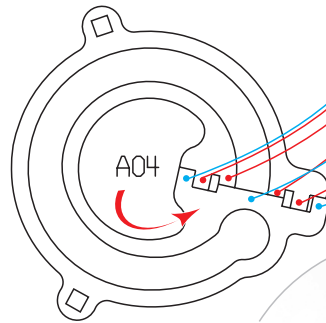

4

Locate A02 (1 pc.)

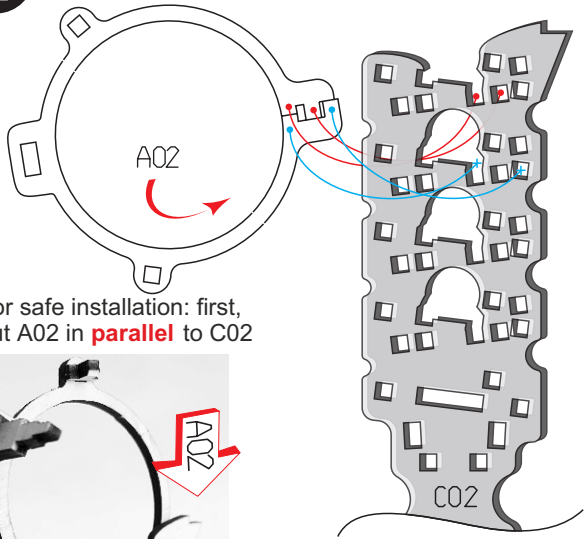

TIPS & TRICK

For safe installation: first, put A02 in **parallel** to C02

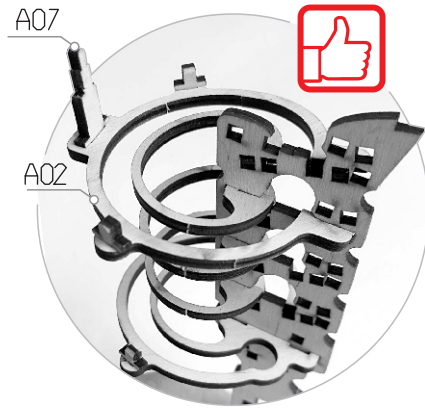
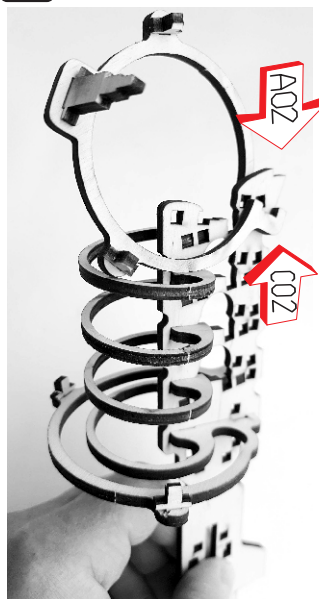

5

Locate B02 (1 pc.)

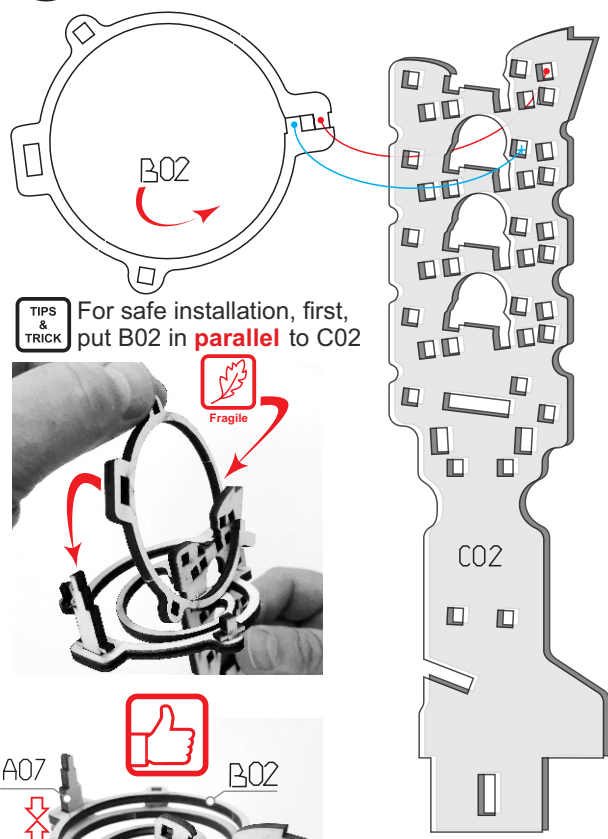

TIPS & TRICK

For safe installation, first, put B02 in **parallel** to C02

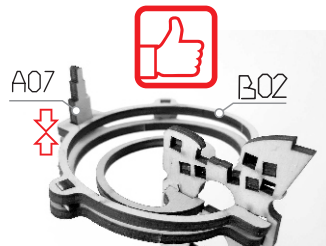
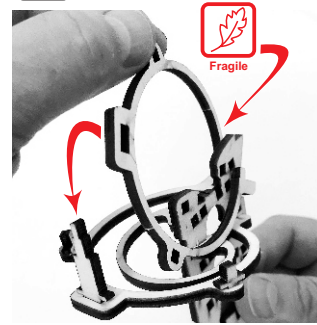

**6** Locate B04 (2 pcs)

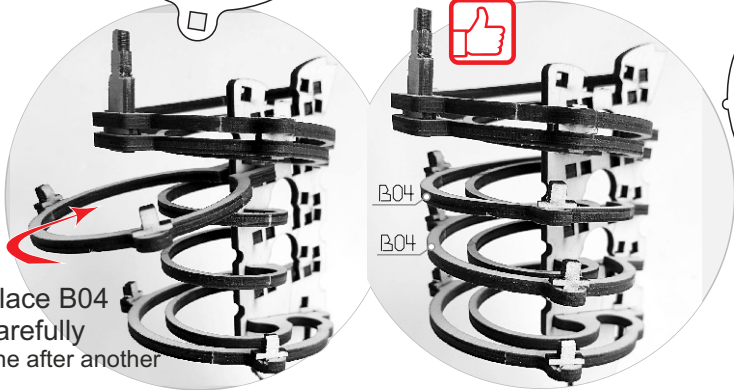
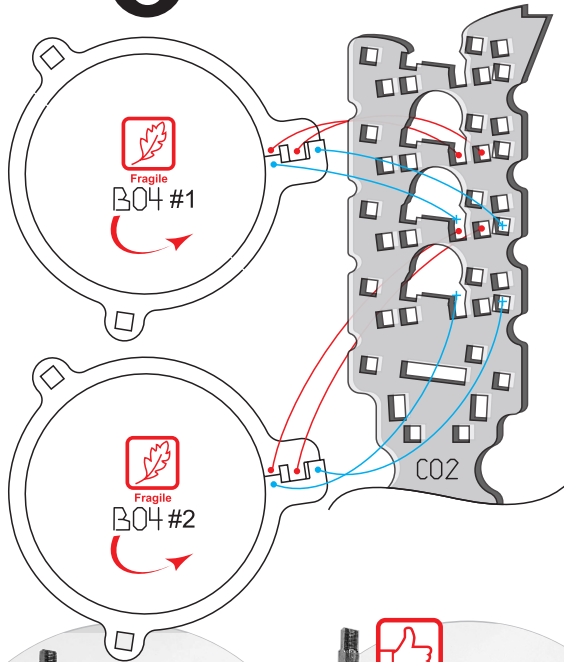

Place B04  
carefully  
one after another

**7** Locate B03 (3 pcs)

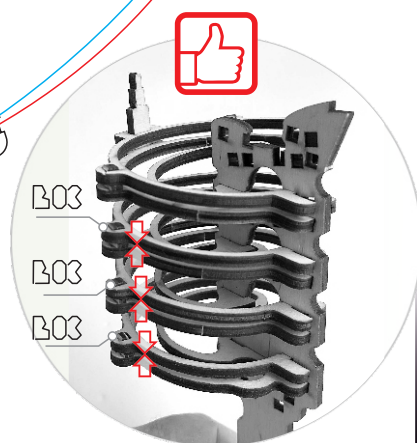
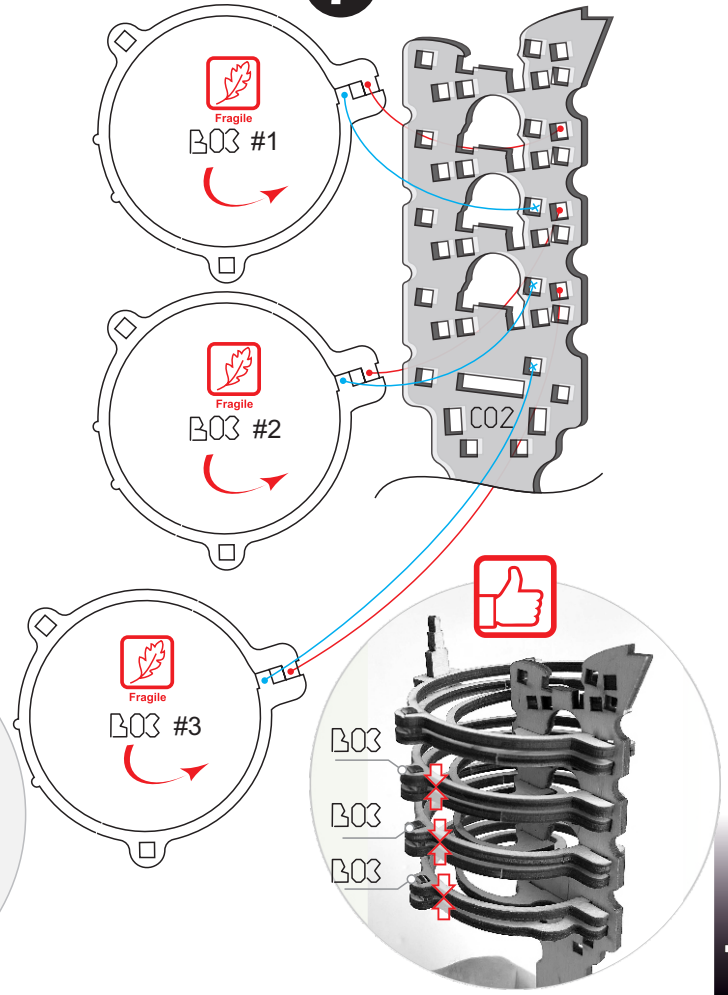

**8** Locate A01 (1 pc.) and A05 (1 pc.)

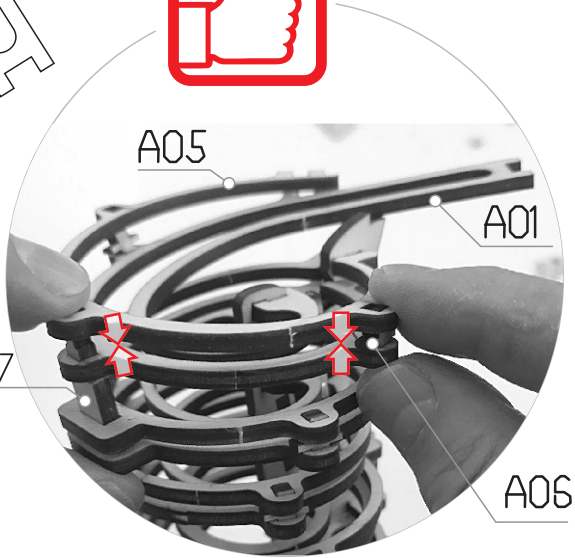
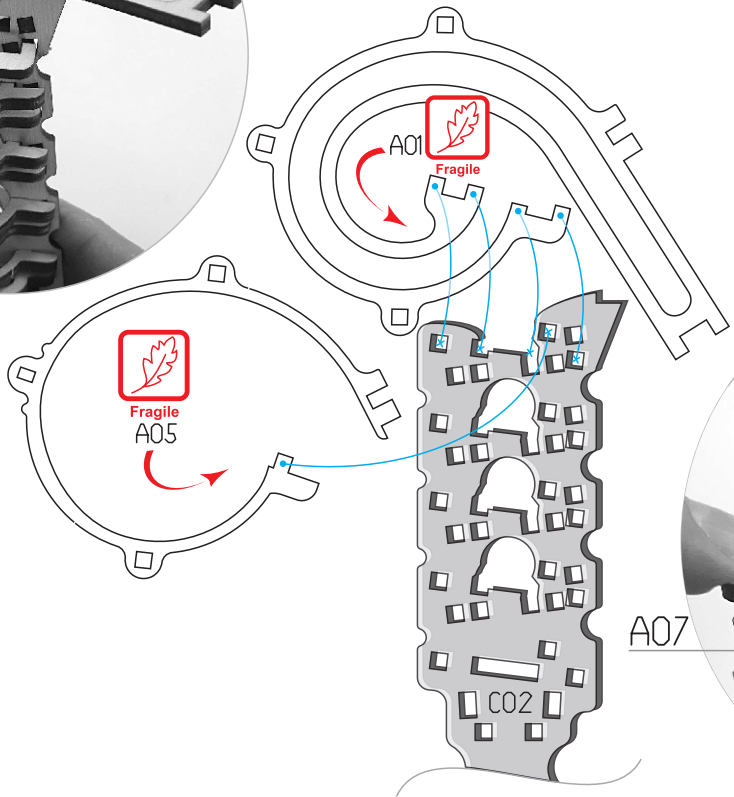

### Upside-down view

9

Locate C08 (2 pcs)

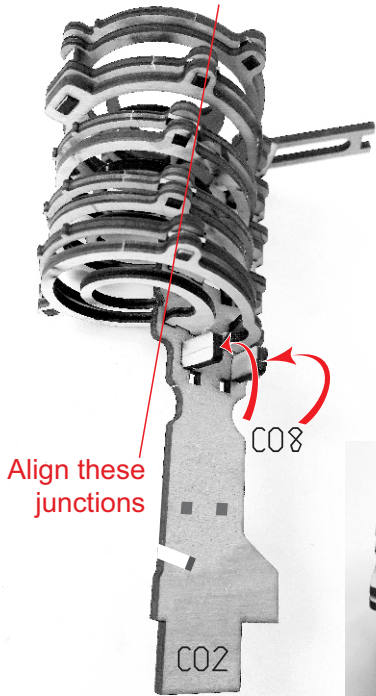

Align these junctions

Left track complete



### Top view

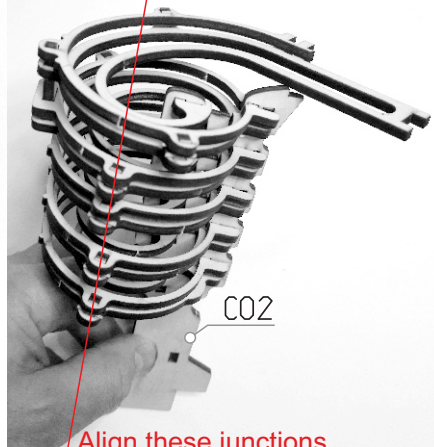

Align these junctions

## Assembling the right track

Locate A06 (10 pcs) and A07 (1 pc.)

1

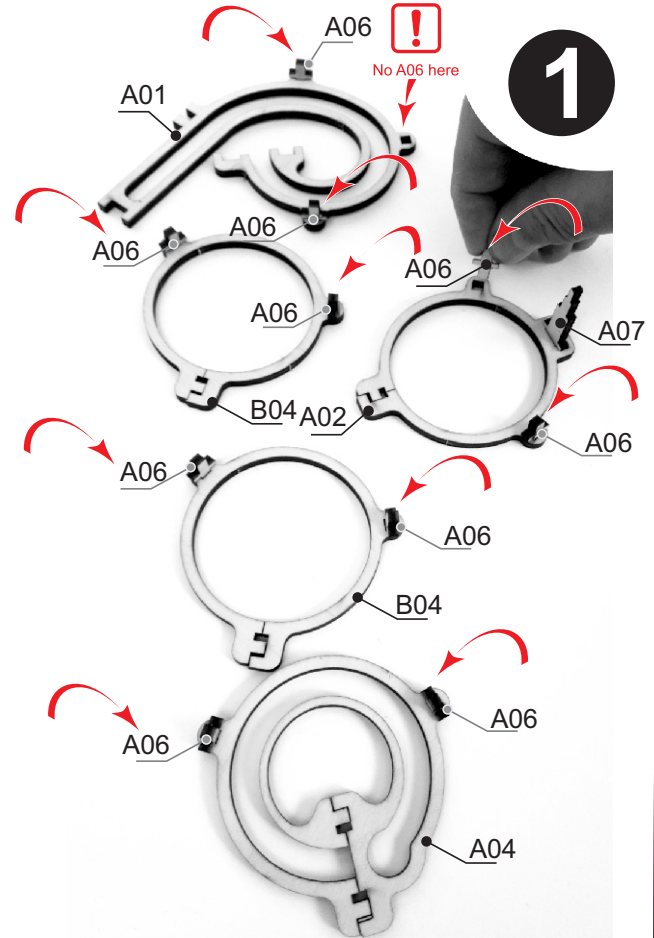

TIPS & TRICK

For safe installation: first, put A03 in **parallel** to C01

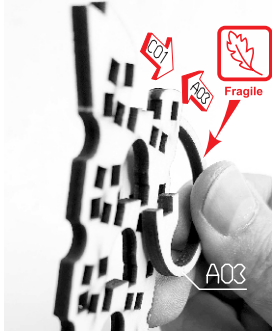

Then rotate clockwise

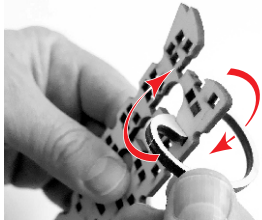

Repeat the operation for all three A03



## 2 Locate A03 (3 pcs)

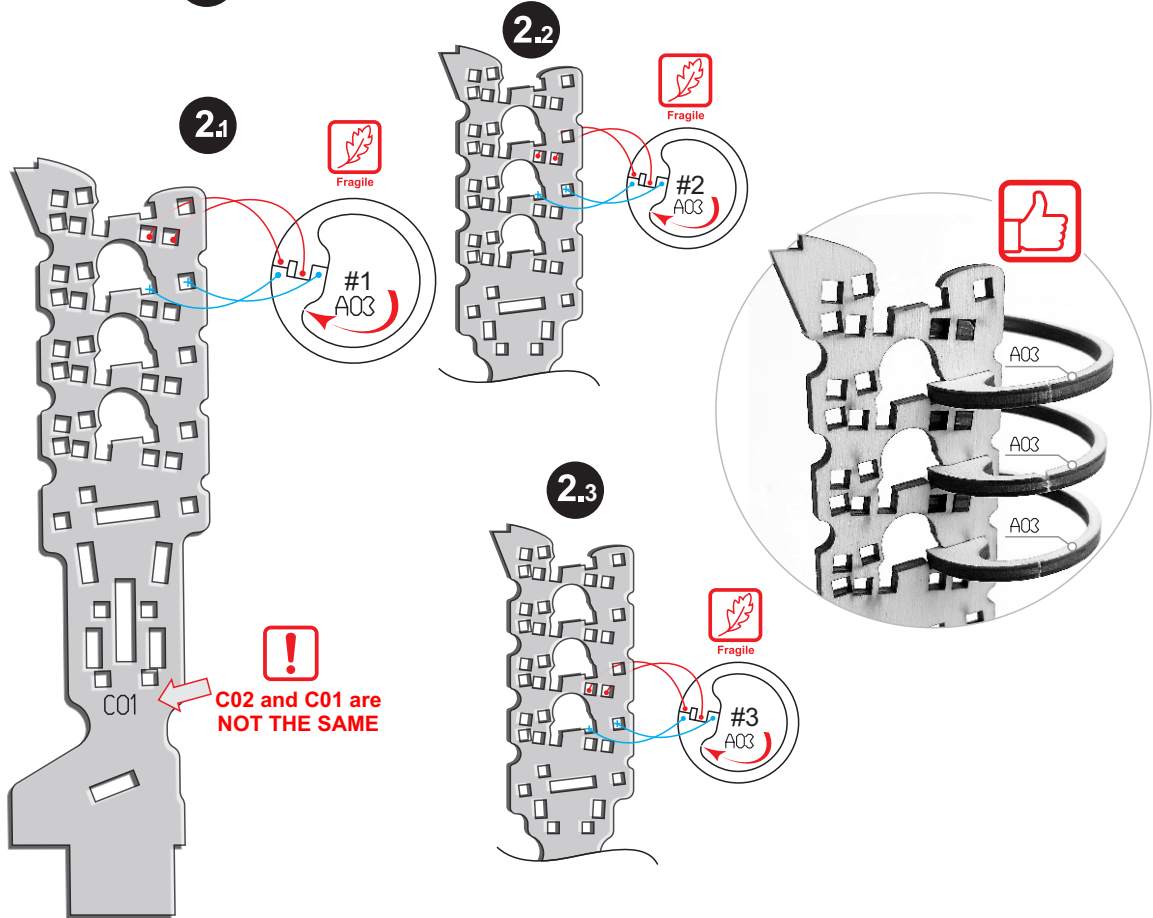

**3** Locate A04 (1 pc.)

TIPS & TRICK

For safe installation:  
first, put A04 in **parallel** to C01

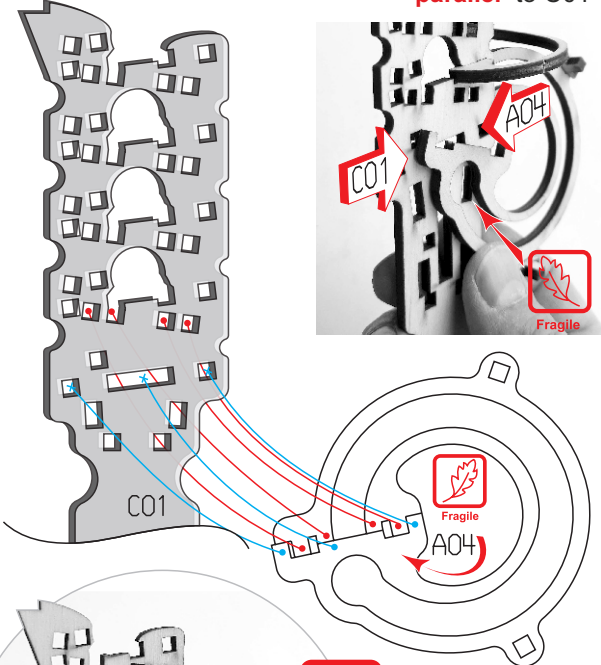

**4** Locate A02 (1 pc.)

TIPS & TRICK

For safe installation: first,  
put A02 in **parallel** to C01

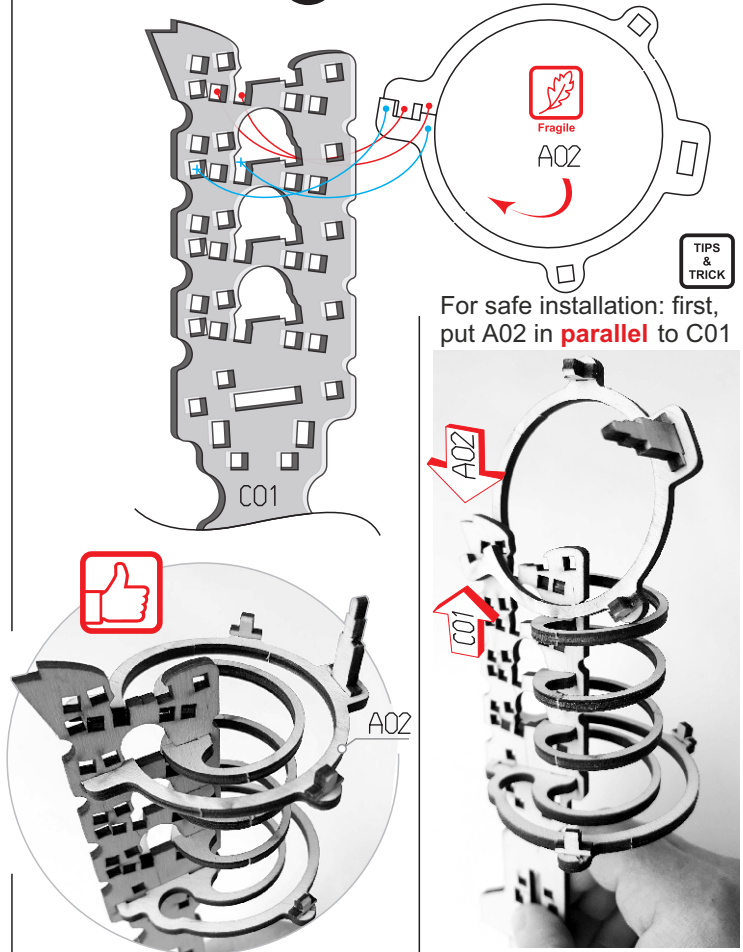

**5** Locate B02 (1 pc.)

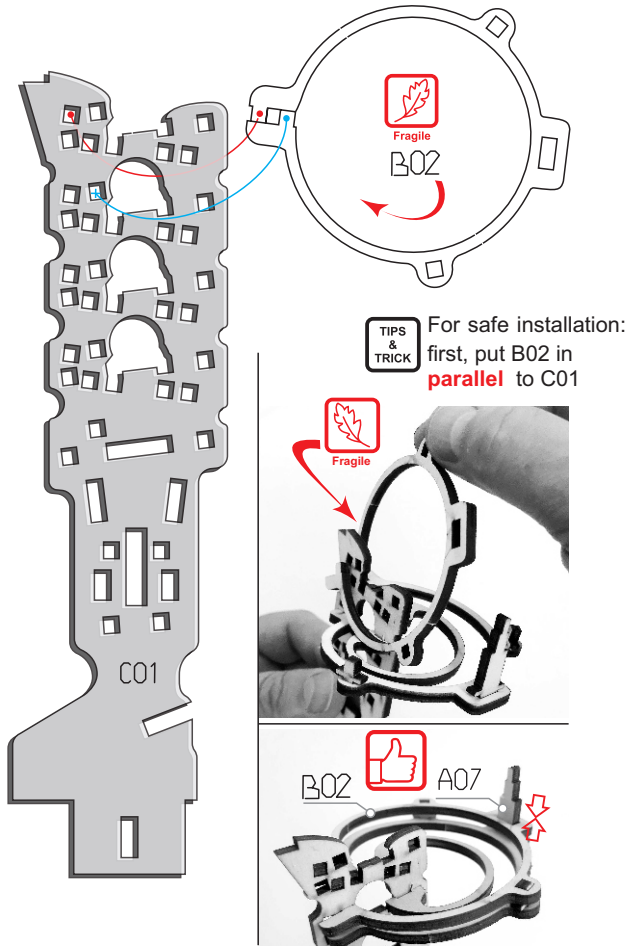

**6** Locate B04 (2 pcs)

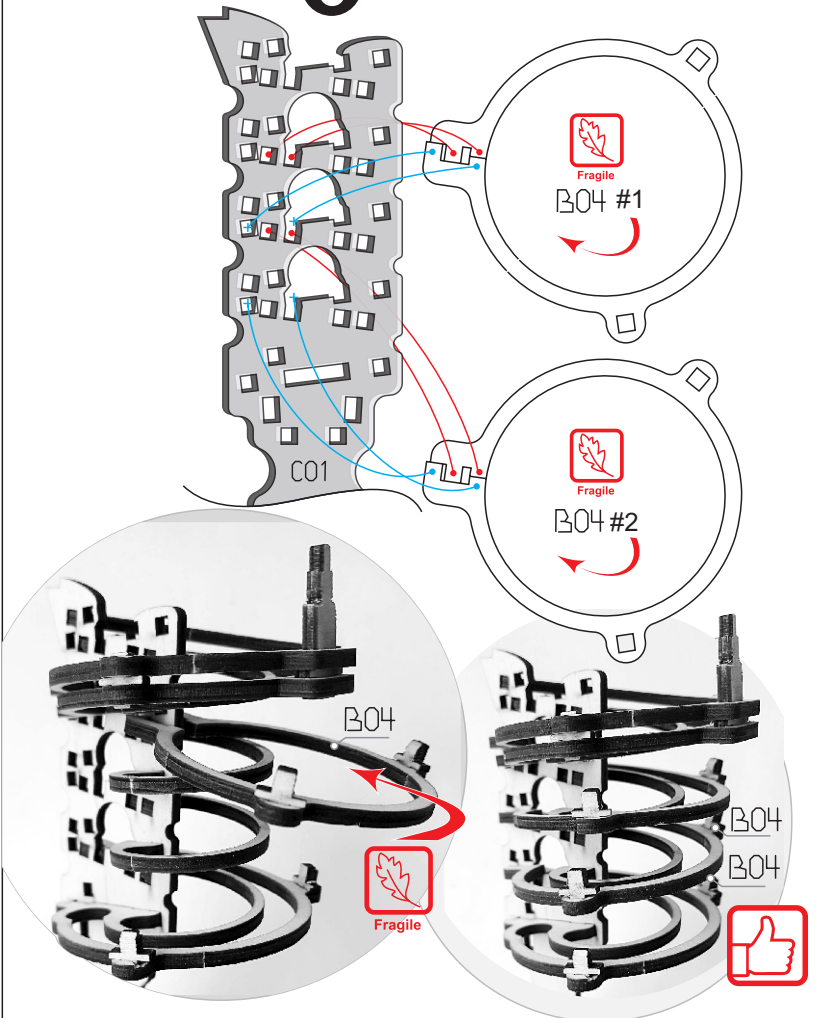



**7** Locate B03 (3 pcs)

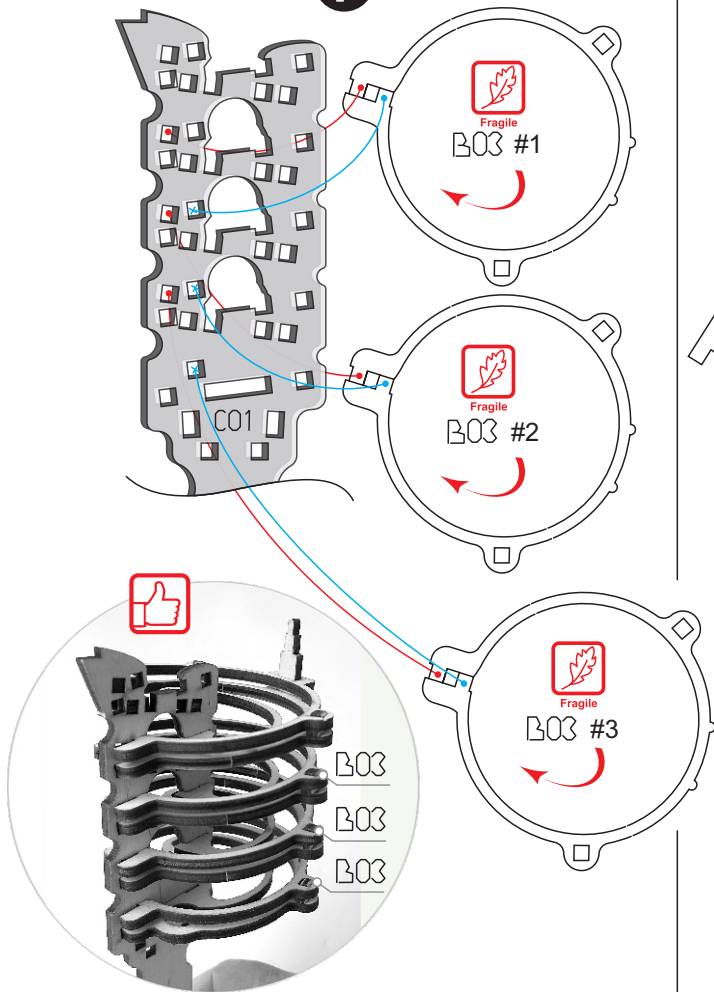

**8** Locate A01 (1 pc.) and A05 (1 pc.)

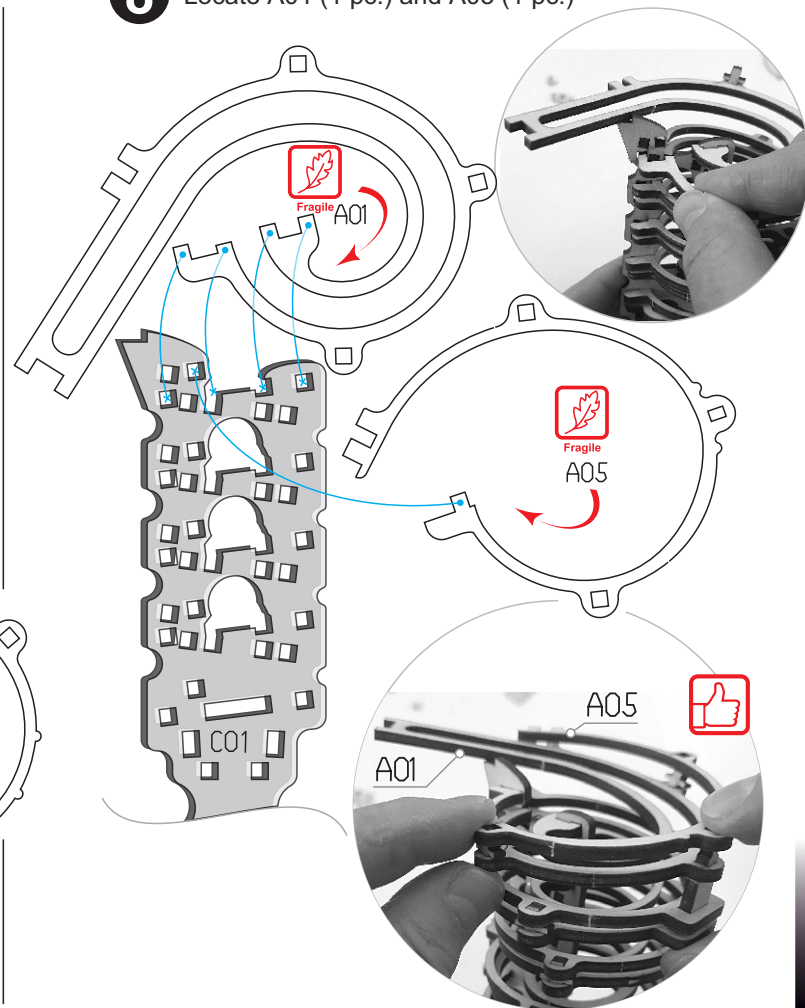

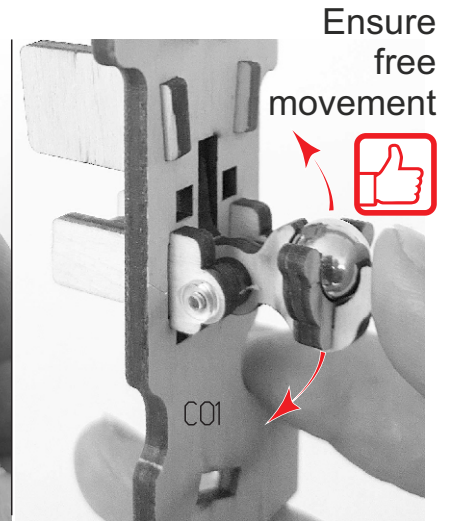
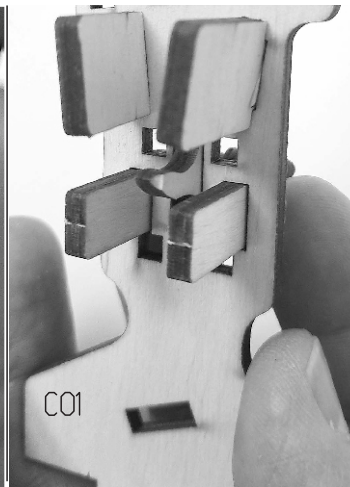
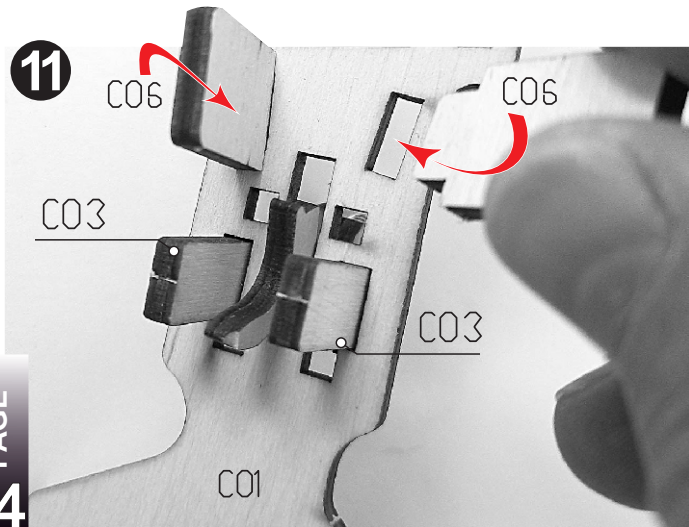
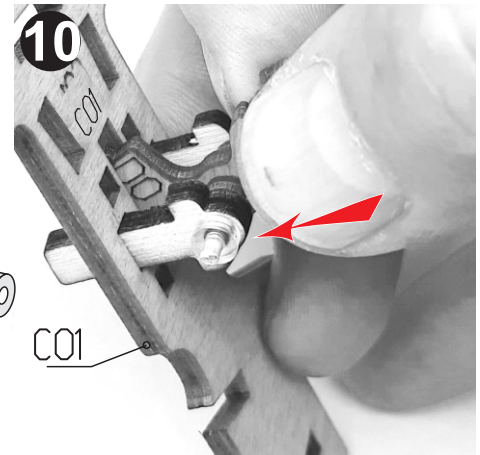
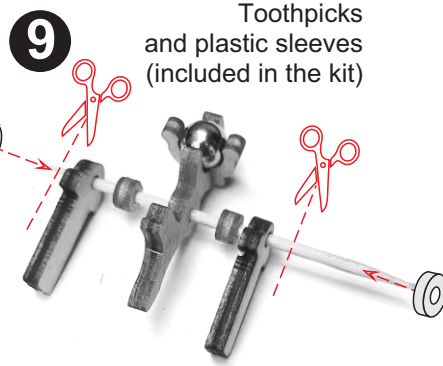
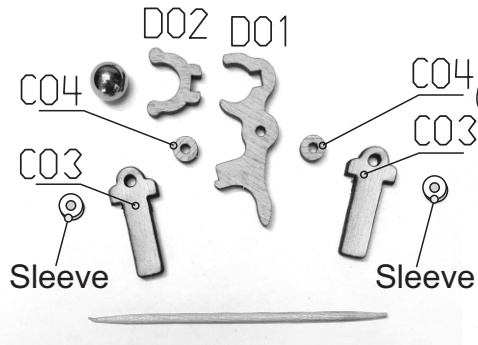

# Assembling the base

**1** Locate F06 (2\*4 pcs)

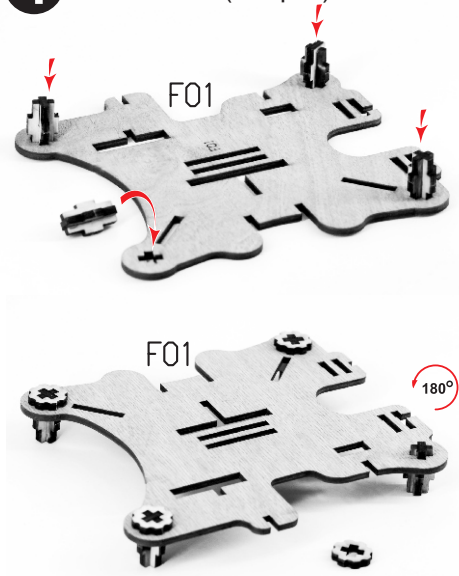

**2** Locate F03 (4 pcs)

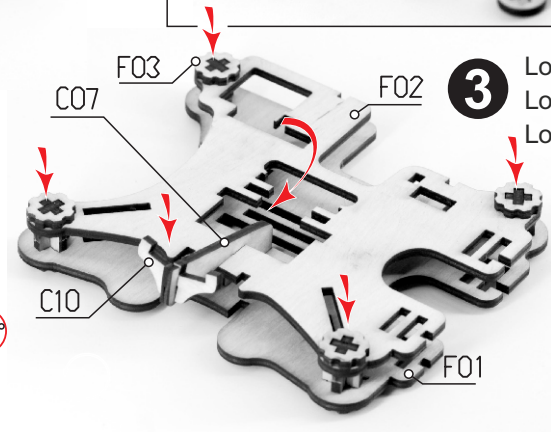
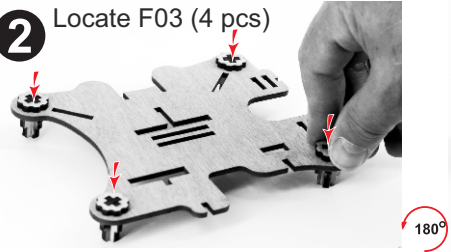

**3** Locate F02  
Locate F03 (4 pcs)  
Locate C07 & C10



base complete

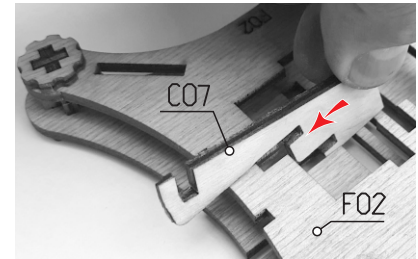

# Assembling the main stand

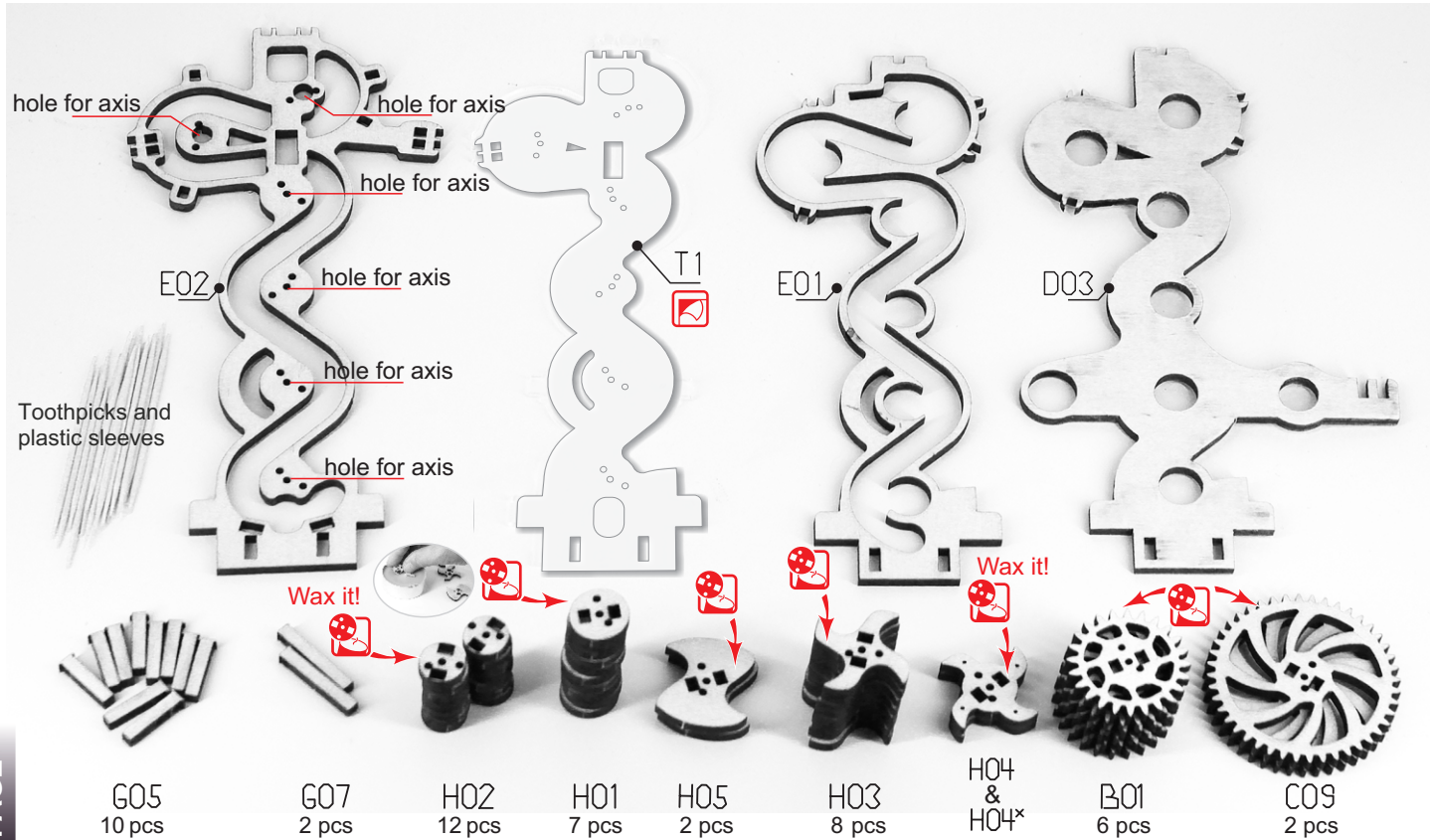

**It is strongly recommended to wax all surfaces subjected to friction.**

**1.1** Put on the sleeves on 6 toothpicks (axes)

**2** Locate the guides (12 pcs)

**1.2** Locate 6 axes

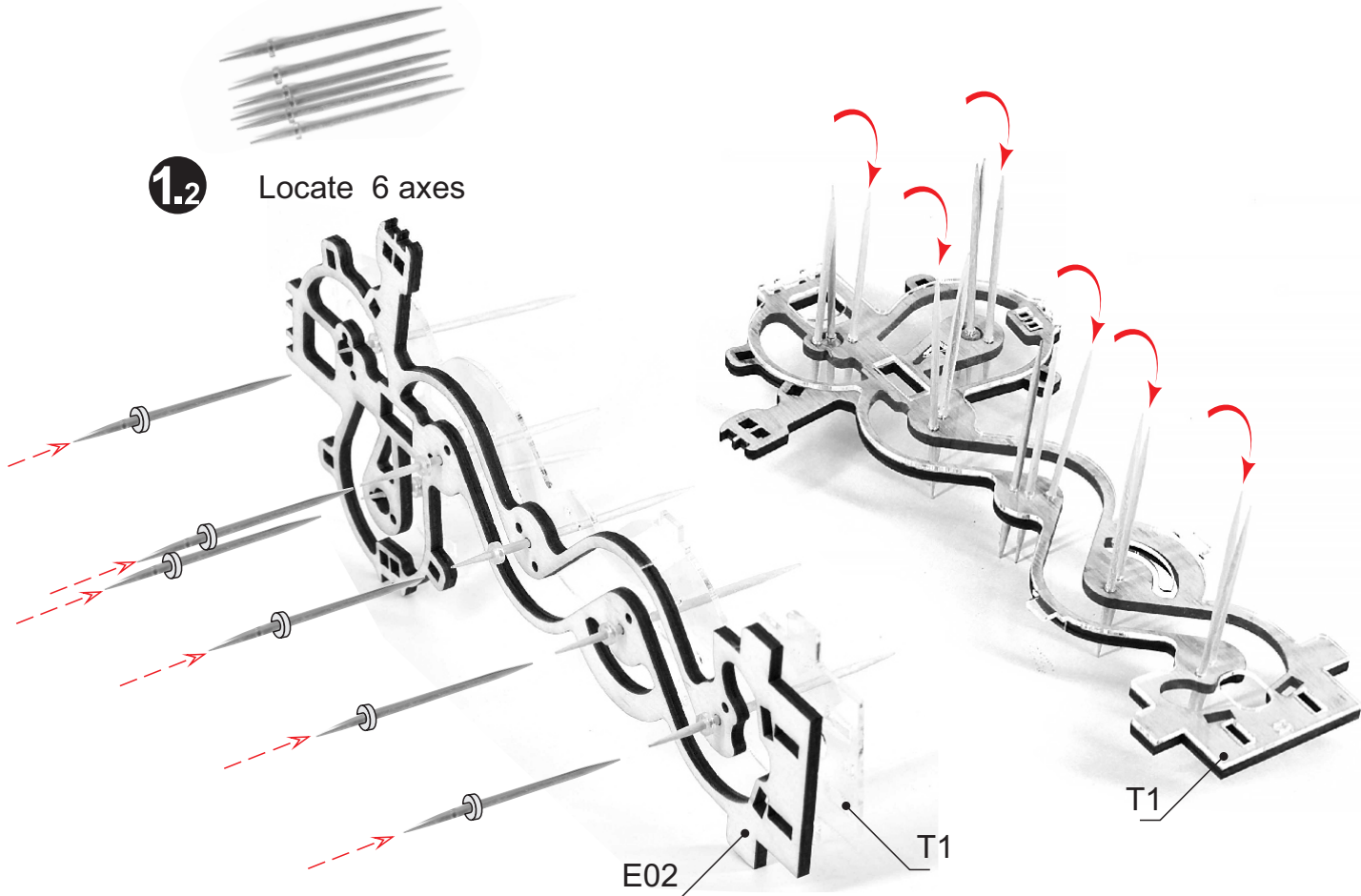

**!** Var. A and B have different positions of holes

**3** Locate H03 (4 pcs),  
H04 (not H04<sup>x</sup>!), H05

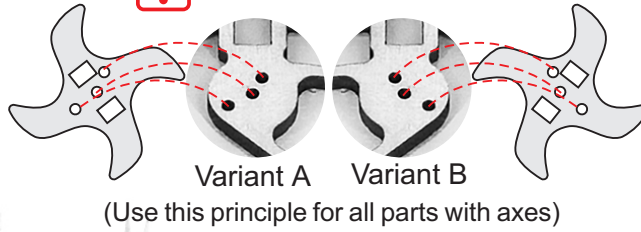

**4** Locate H02 (6 pcs)



H04 is marked  
with 4 holes

H04  
(Var. A)

H03  
(Var. A)

H03  
(Var. B)

H03  
(Var. A)

H05  
(Var. A)

H03  
(Var. B)

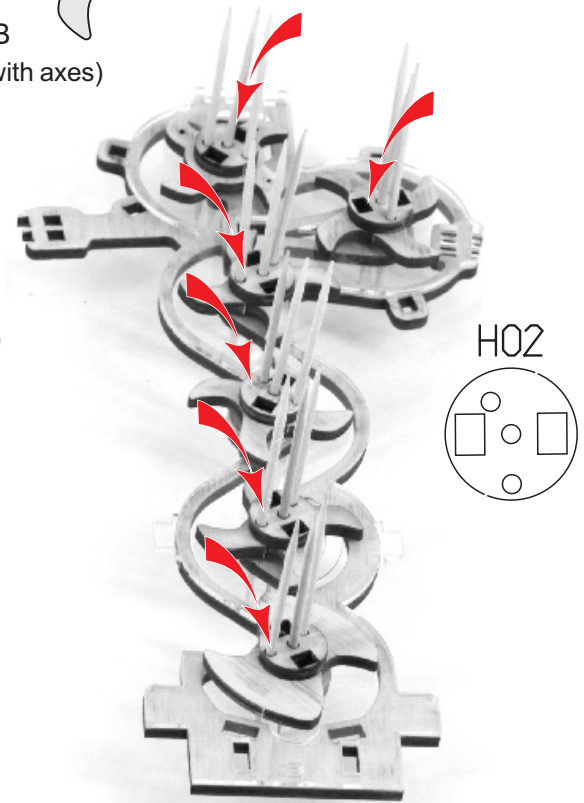

H02

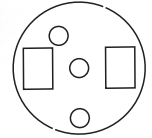

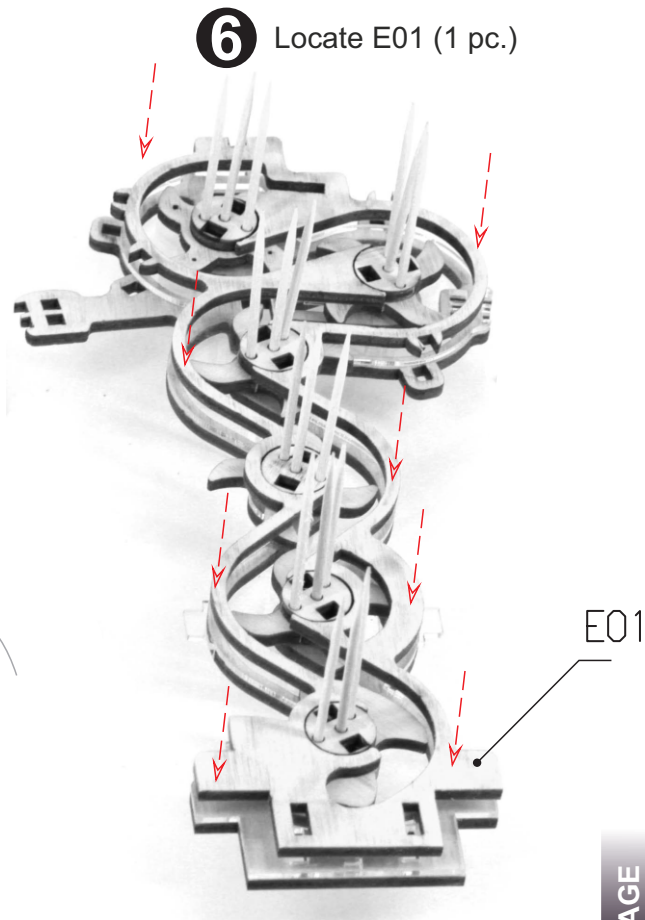
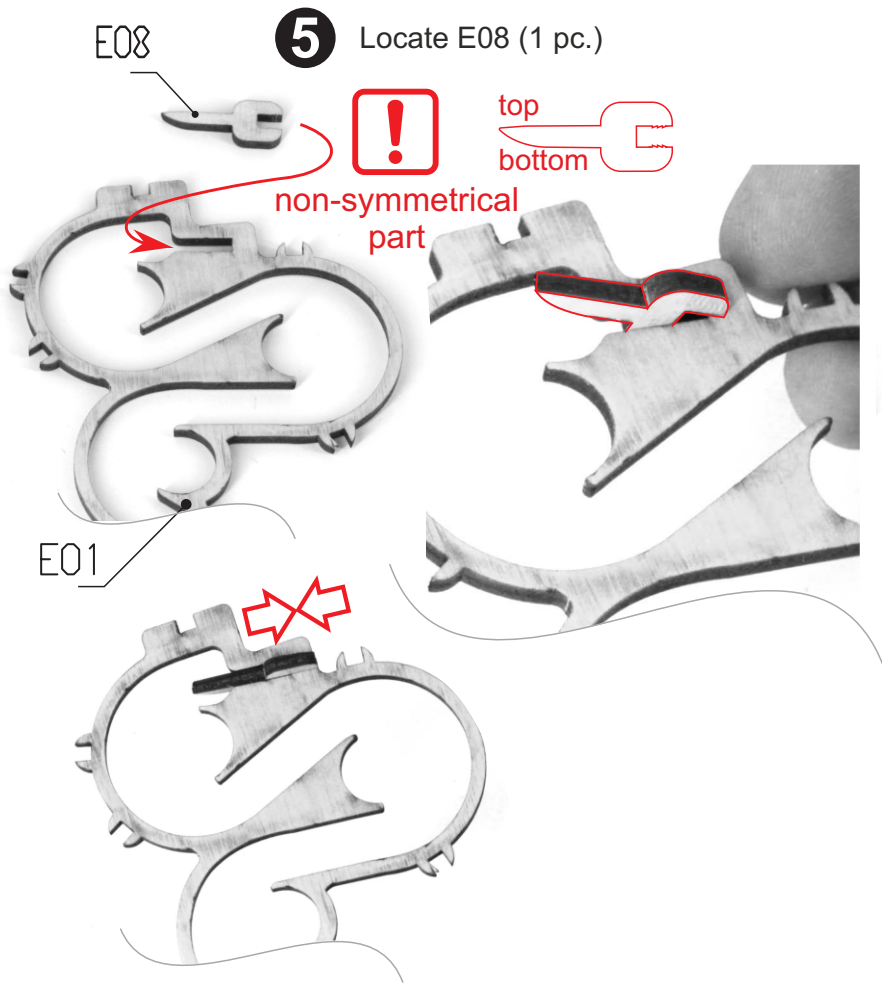

**7** Locate H03 (4 pcs), H04<sup>x</sup>, H05



H04<sup>x</sup> is marked with 1 hole

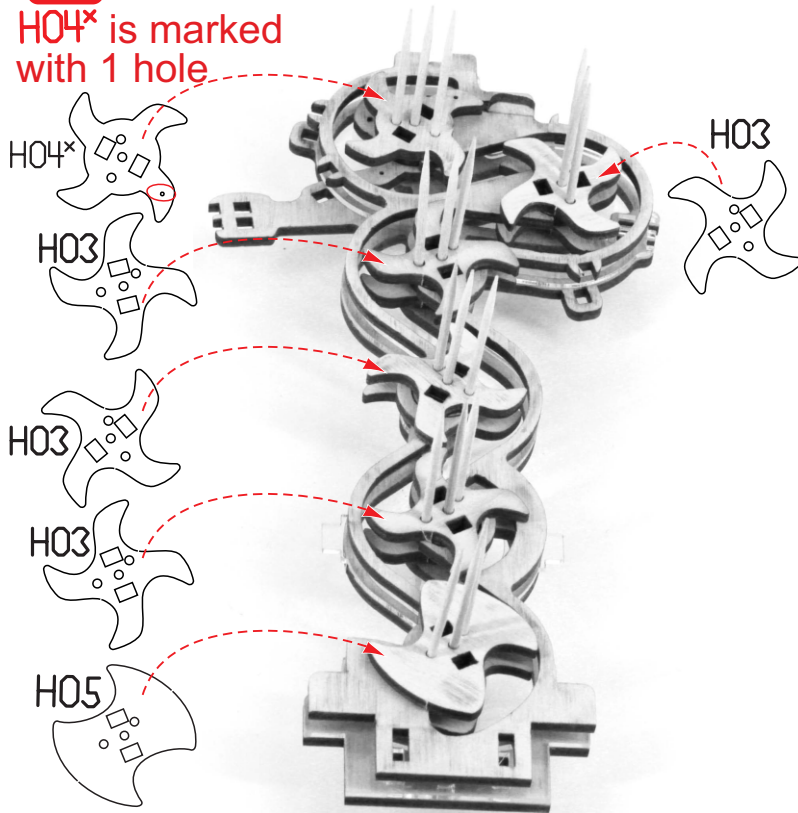

**8** Locate H02 (6 pcs)

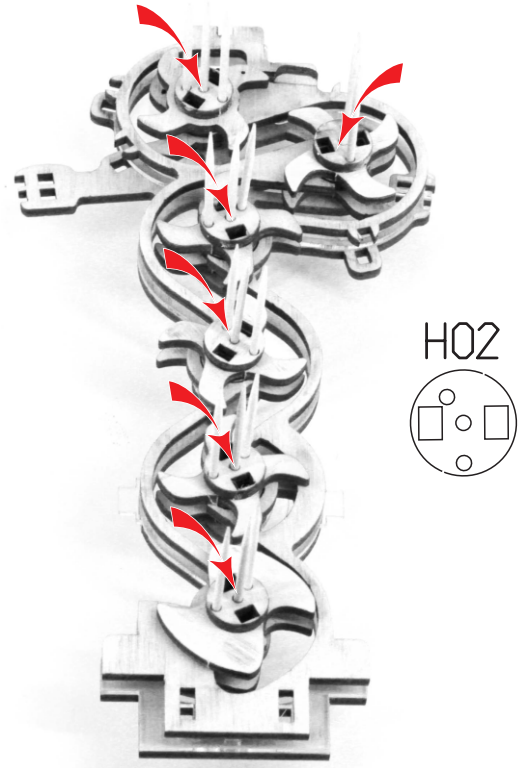



**9** Locate D03

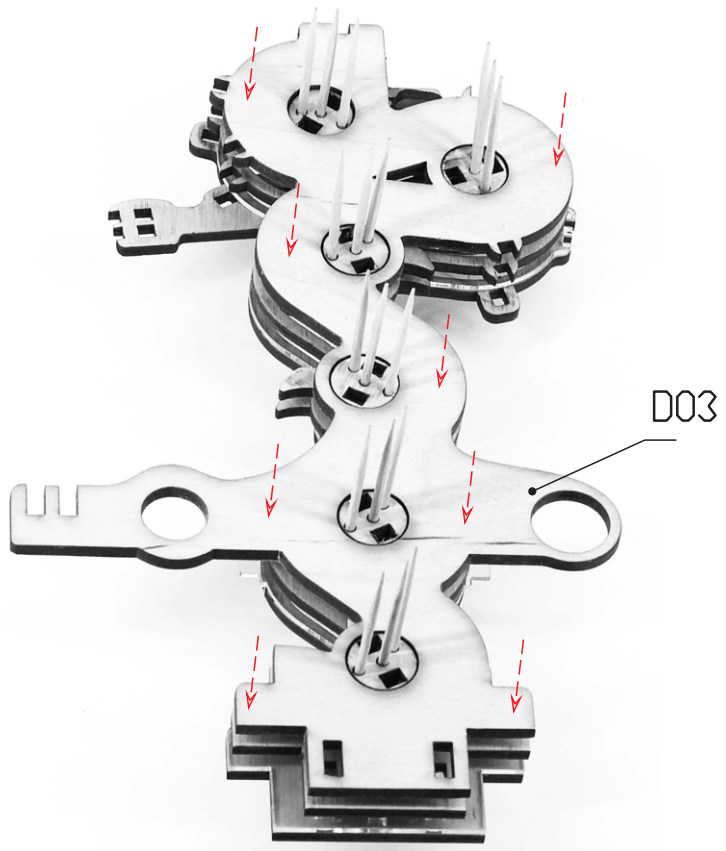

**10** Locate H01 (6 pcs)

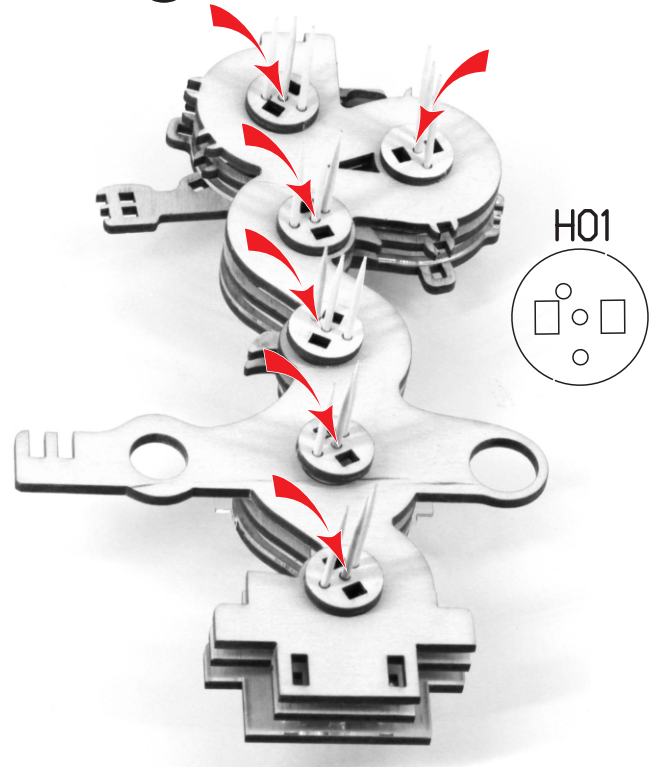

11 Locate B01 (6 pcs)

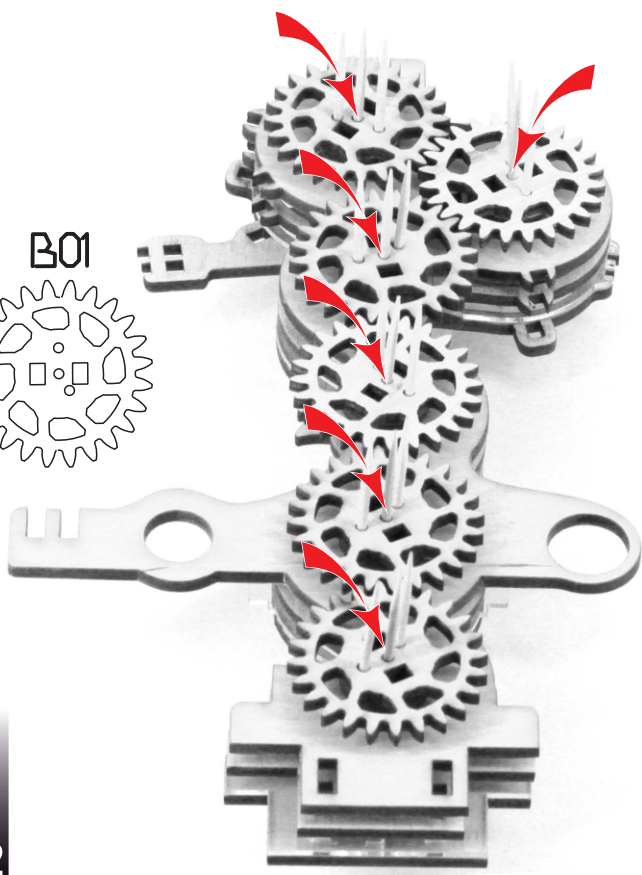
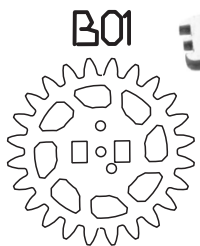

12 Locate fixing pins G05 (10 pcs)

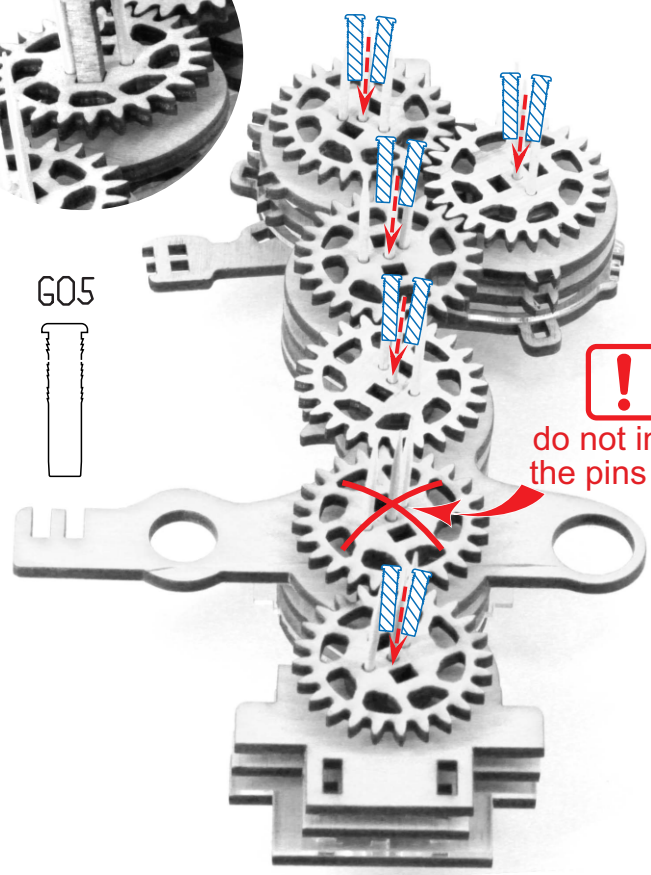
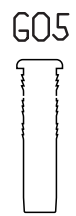

  
do not insert  
the pins here

**13.1**  
Remove  
the guides

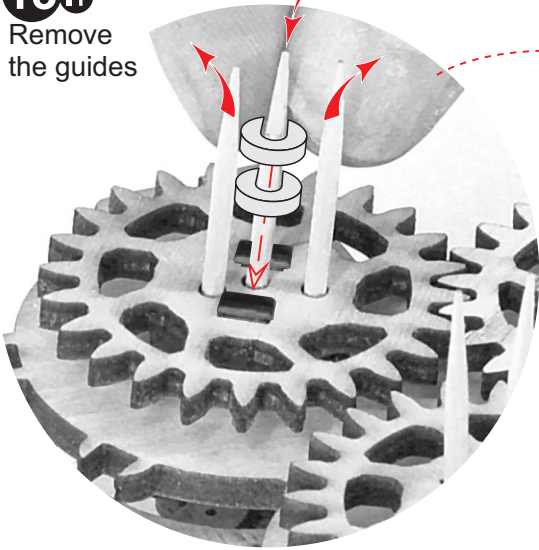

**13.2**

Locate 2 x sleeves

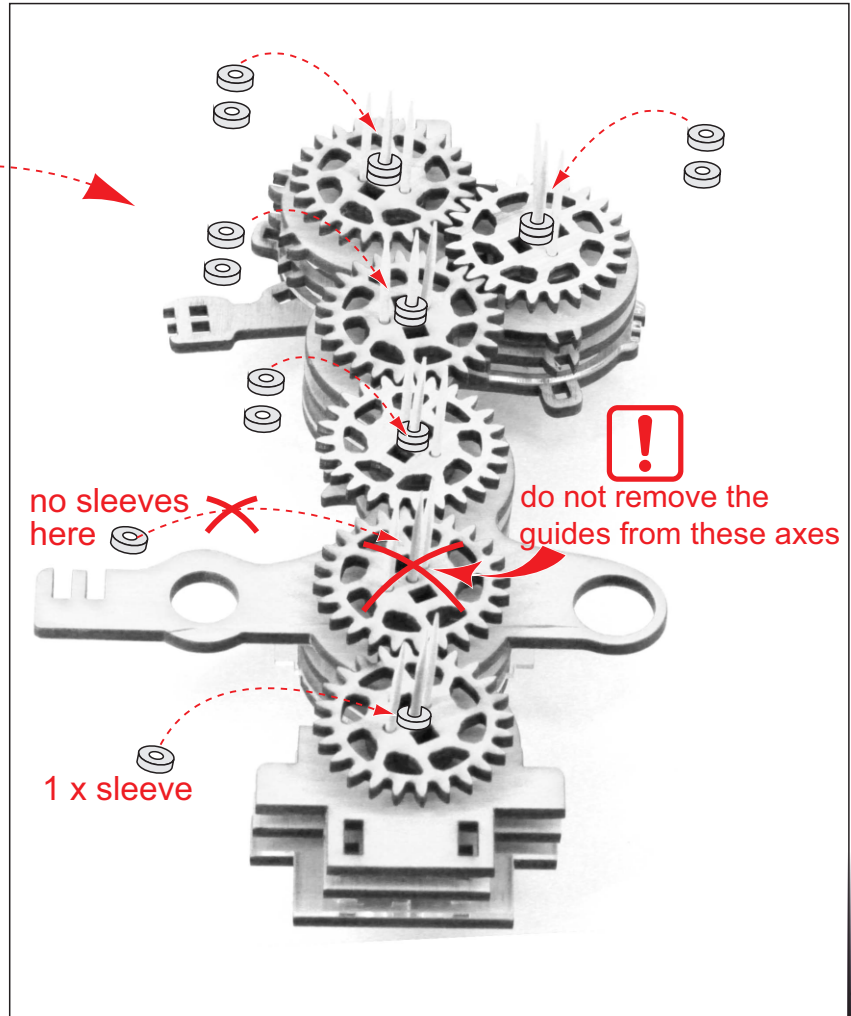

**14** Put 1 x H01 on

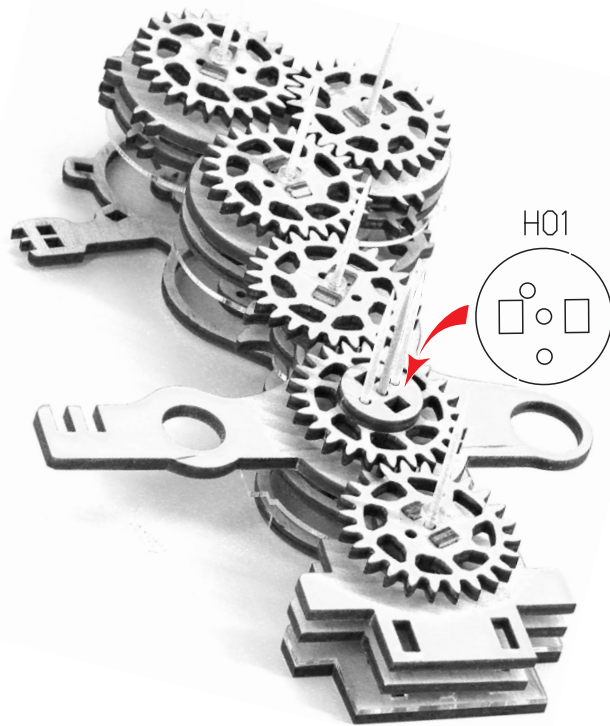

**15** Locate I07 and fix it with sleeves

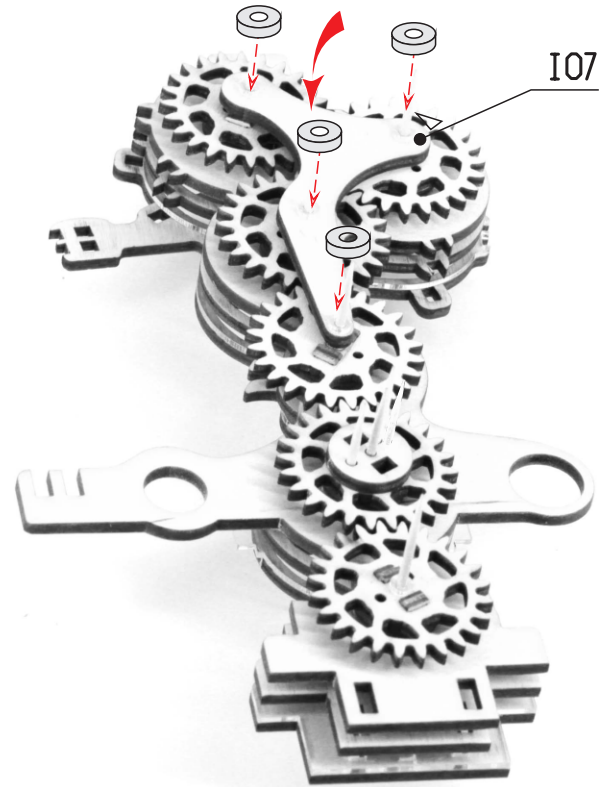

**16** Locate C09 (2 pcs)

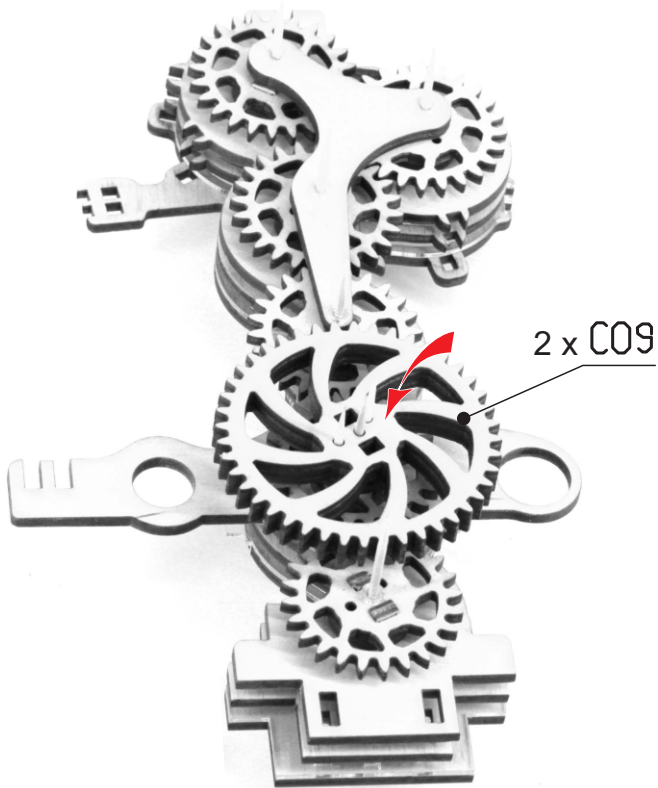

**17<sub>1</sub>** Locate 2 x G07

2 x G07



**17<sub>2</sub>** Remove the guides

**17<sub>3</sub>** Locate 2 x sleeves

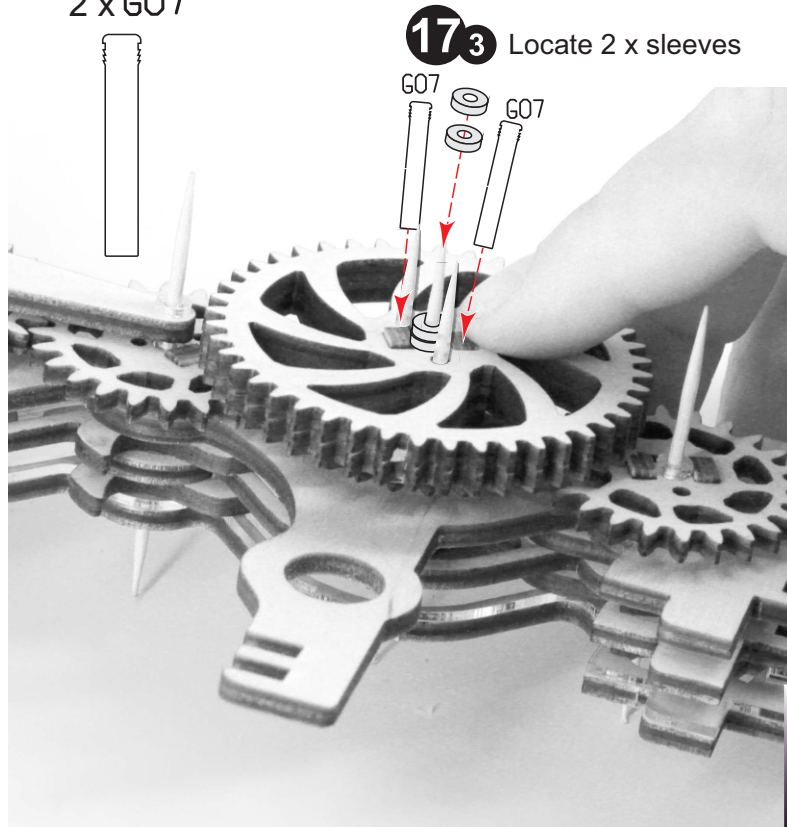

**18** Work out the gear train until the gears move smoothly

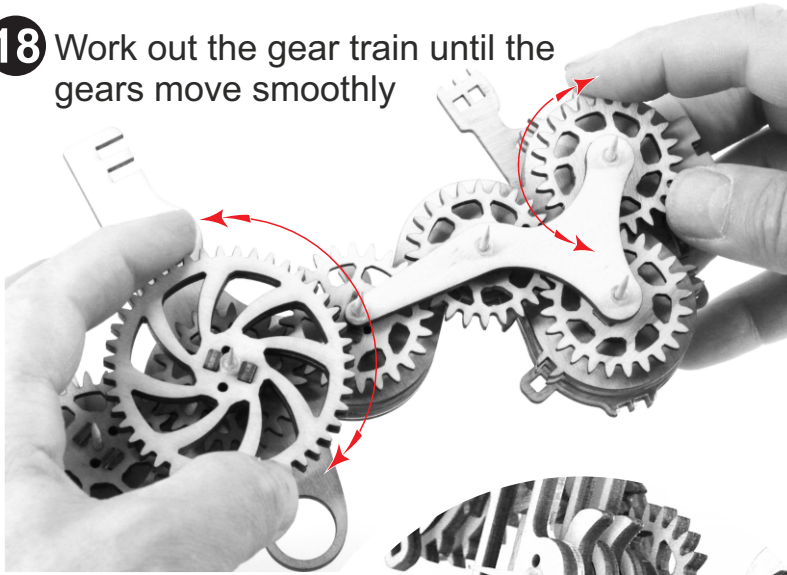

**19** Check that marbles run all the track through

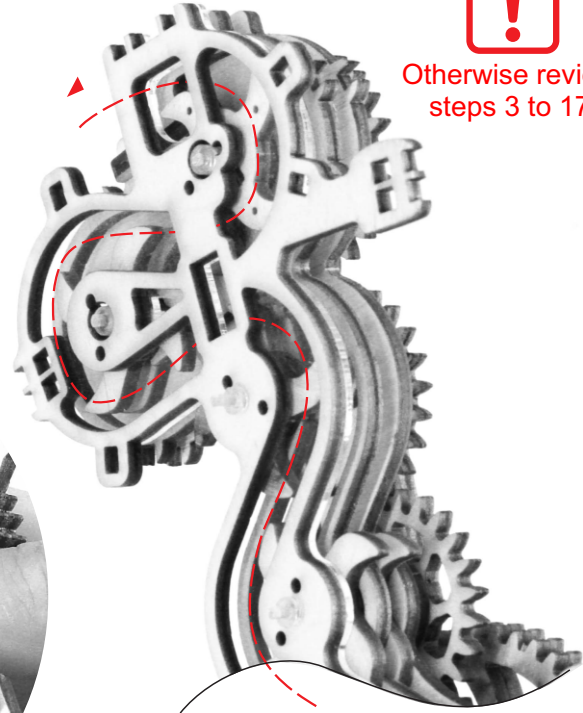

Otherwise review  
steps 3 to 17

**20**



On the **front side** cut off the toothpick excess but leave 2-3 mm

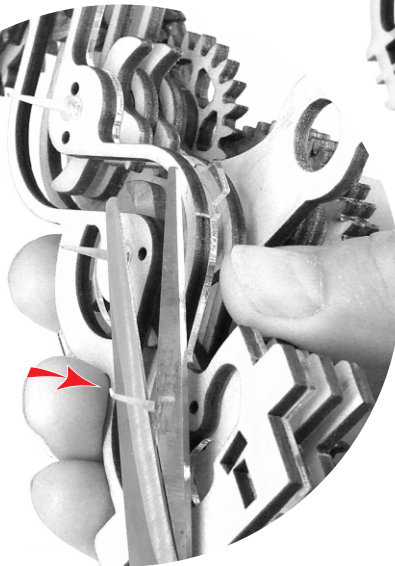

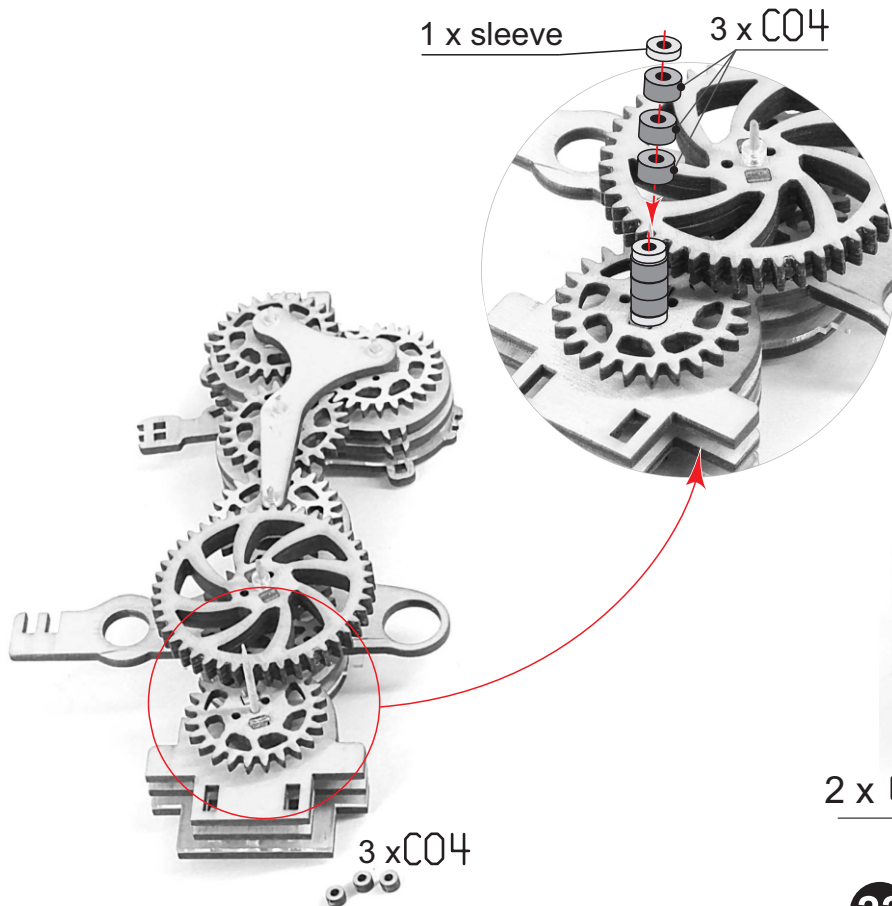

**21** Locate C04 (3 pcs) and 2 sleeves

**22**<sub>1</sub> Locate G01 (2 pcs)

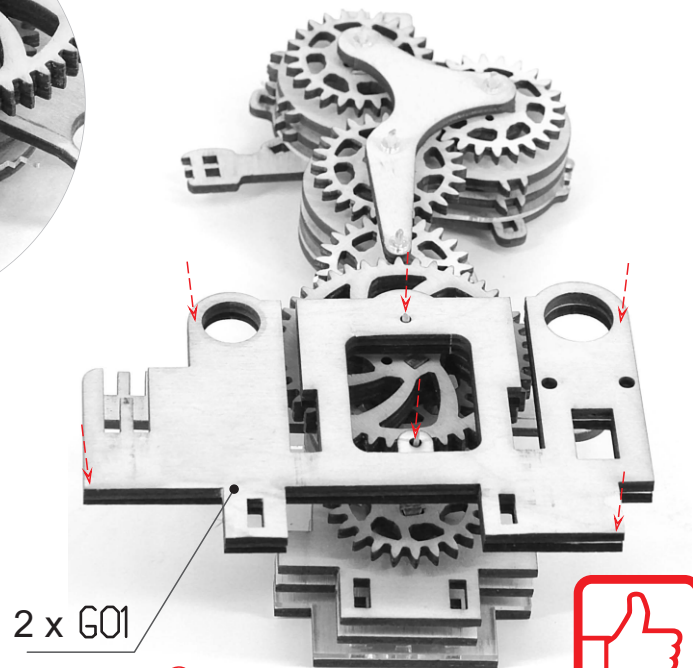

**22**<sub>2</sub> On the **back side** cut off the excess, but leave 2-3 mm



**23** Join the stand to the base

Stand  
Base

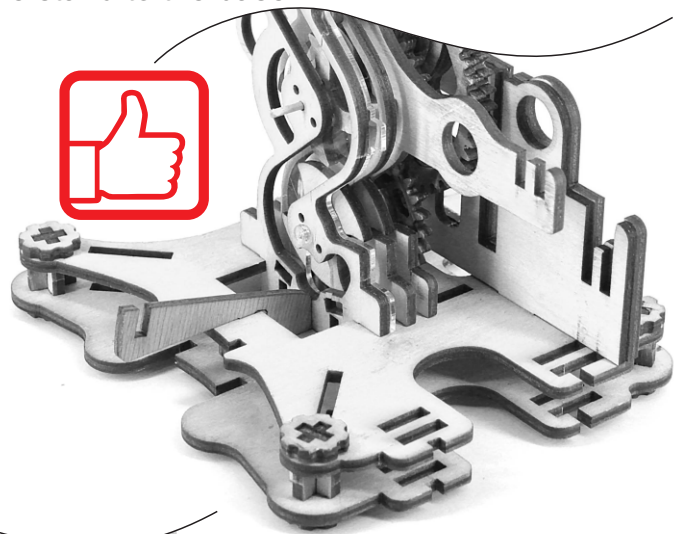
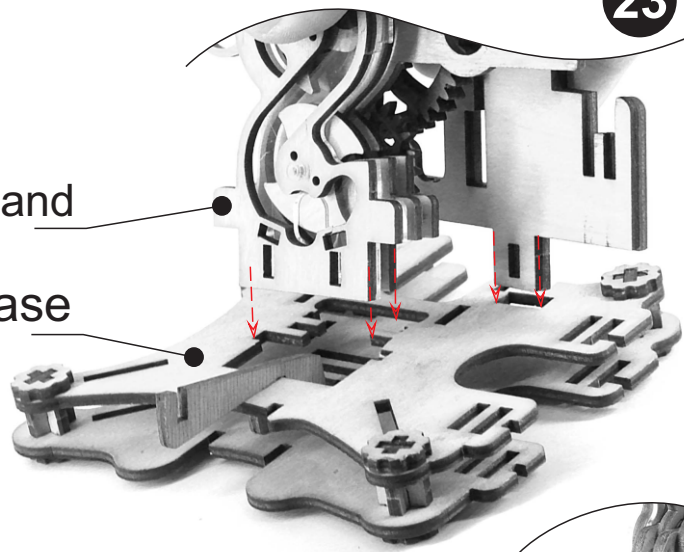

D07

**24** Locate D07

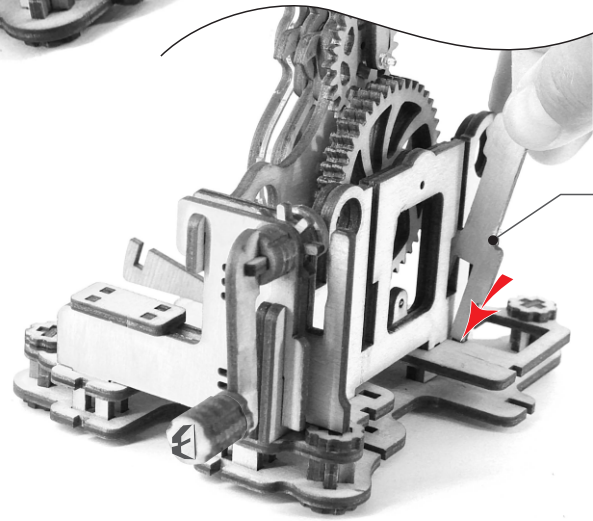



**25** Assemble the handle

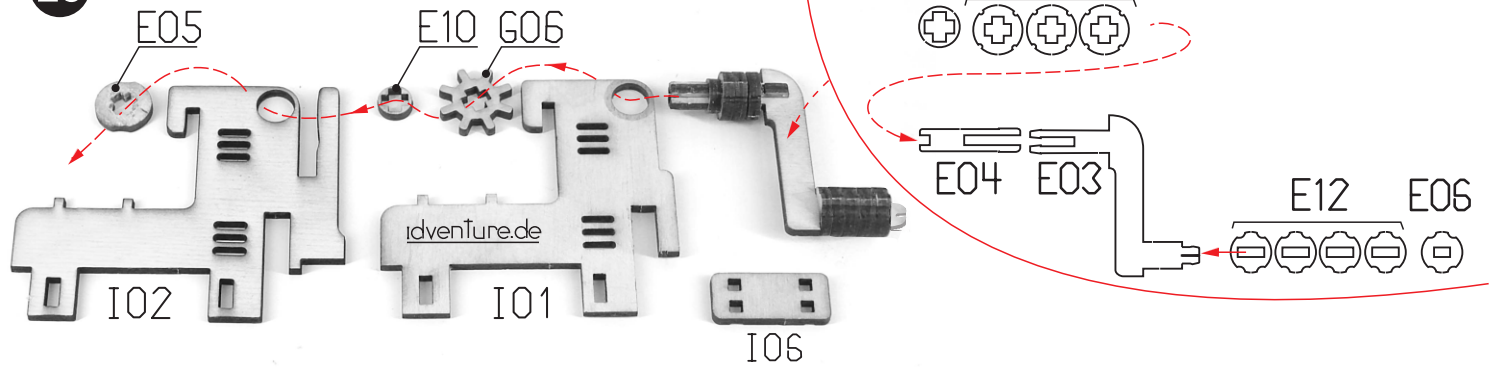

**26** Install the handle

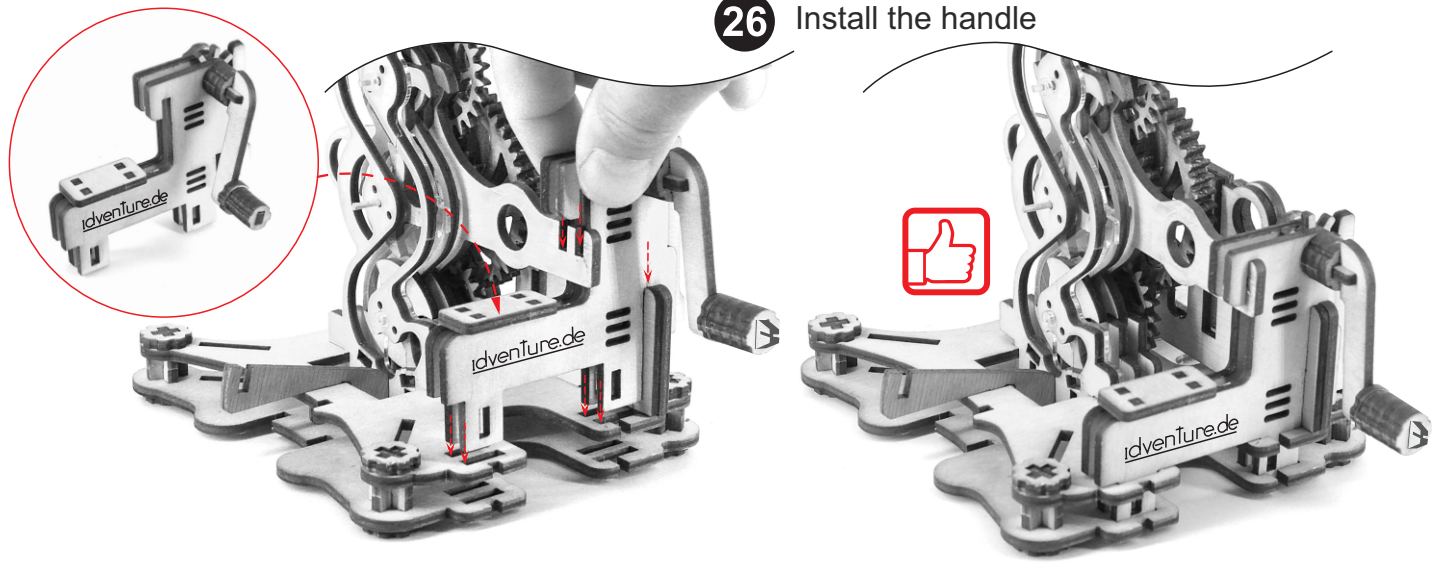

**27<sub>1</sub>** Assemble the next unit

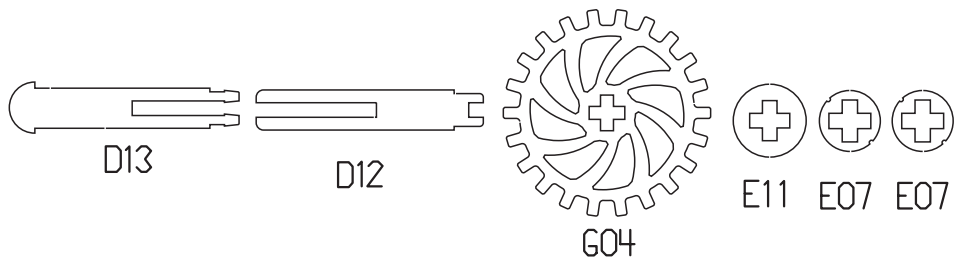

**27<sub>2</sub>** Install the unit

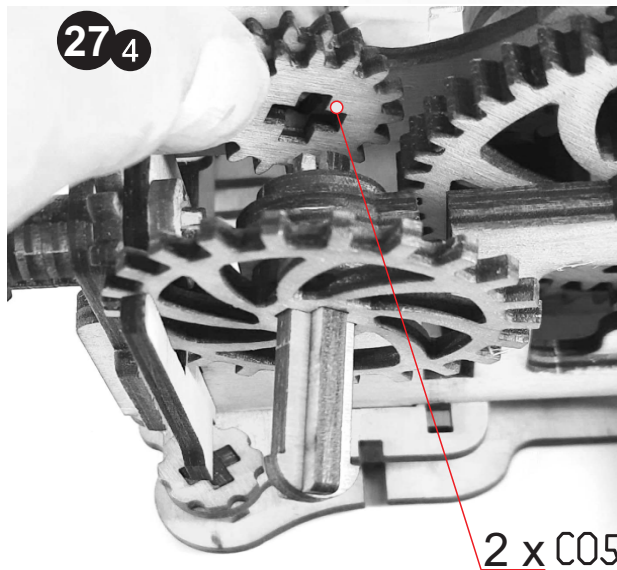
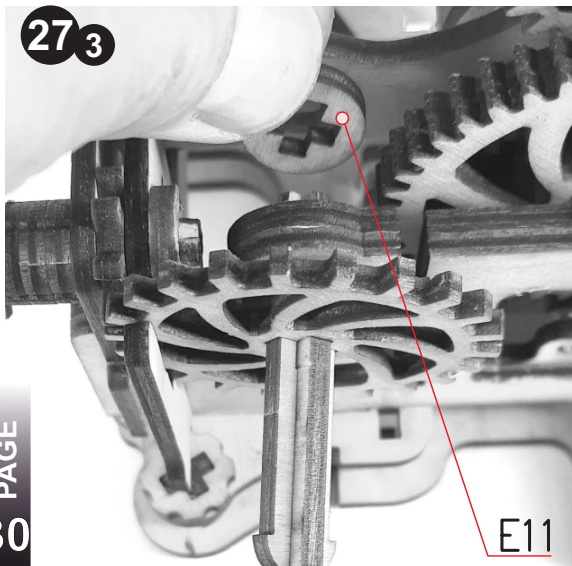
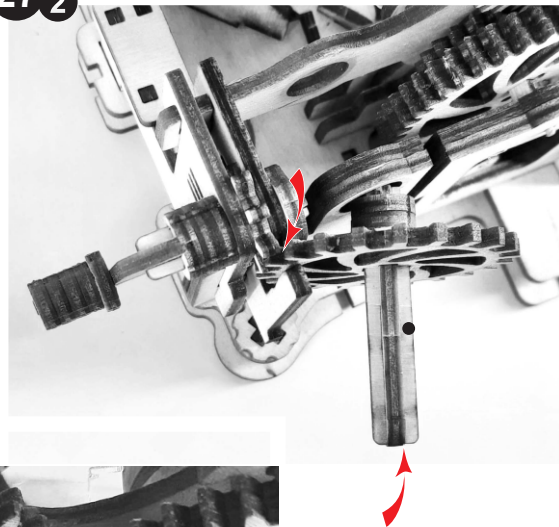

27<sub>5</sub>

3 x E11



27<sub>6</sub>

E07



27<sub>7</sub>

E11



27<sub>8</sub>

E05



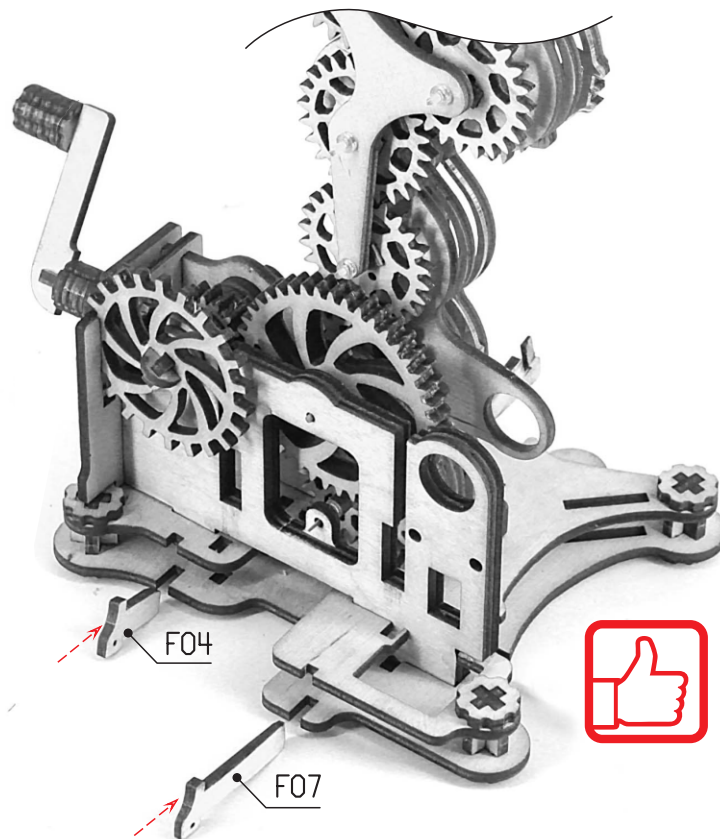
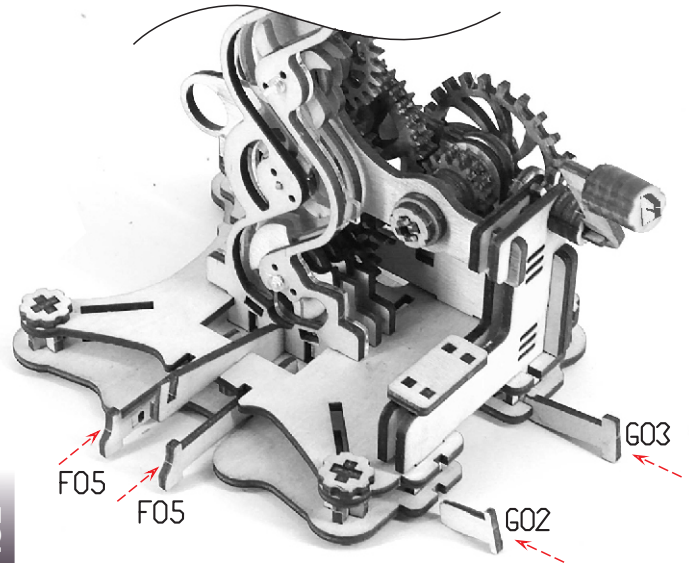
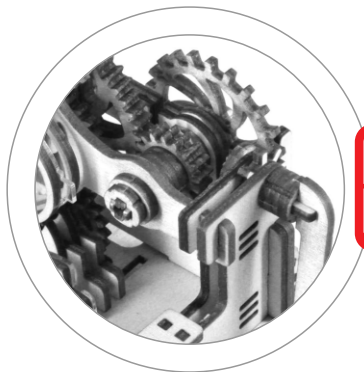

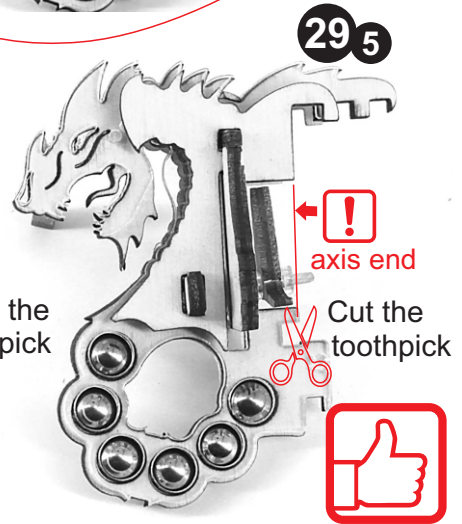
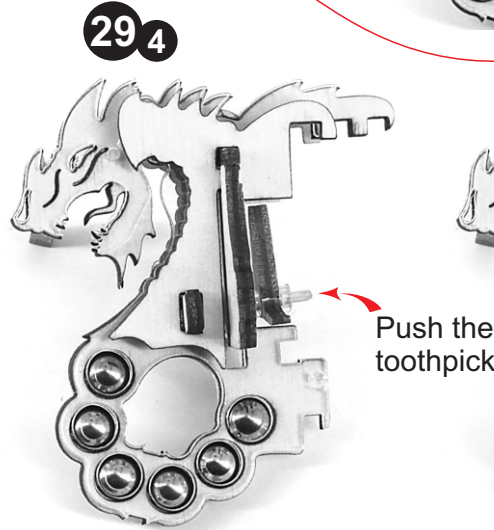
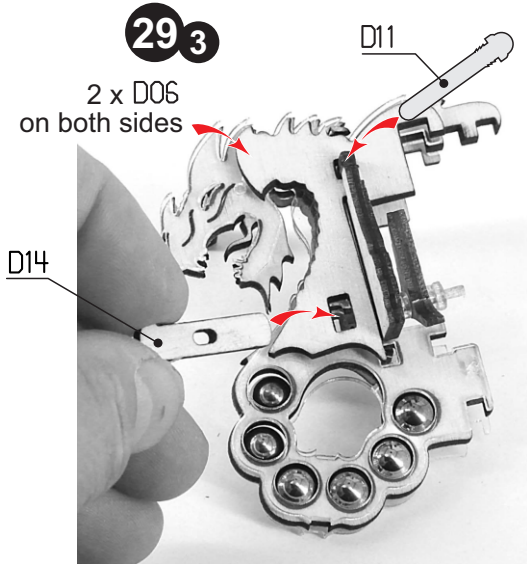
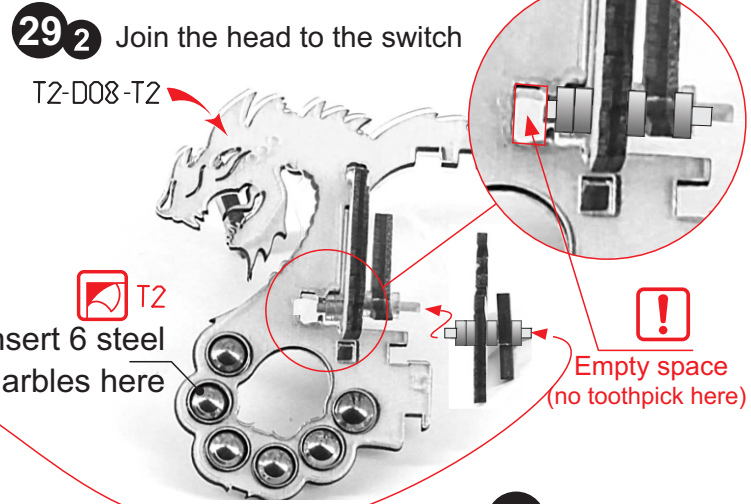
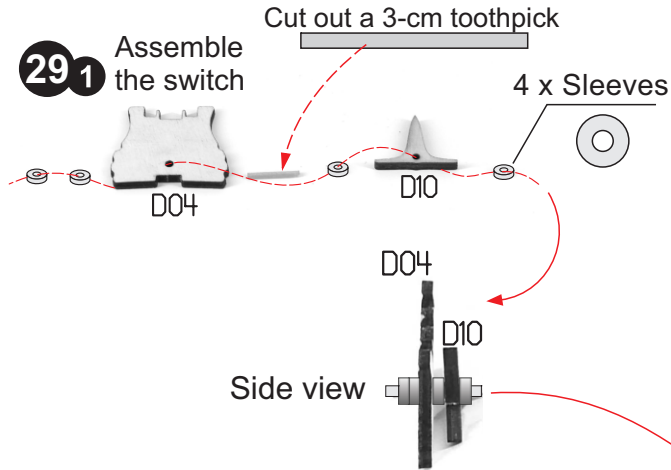

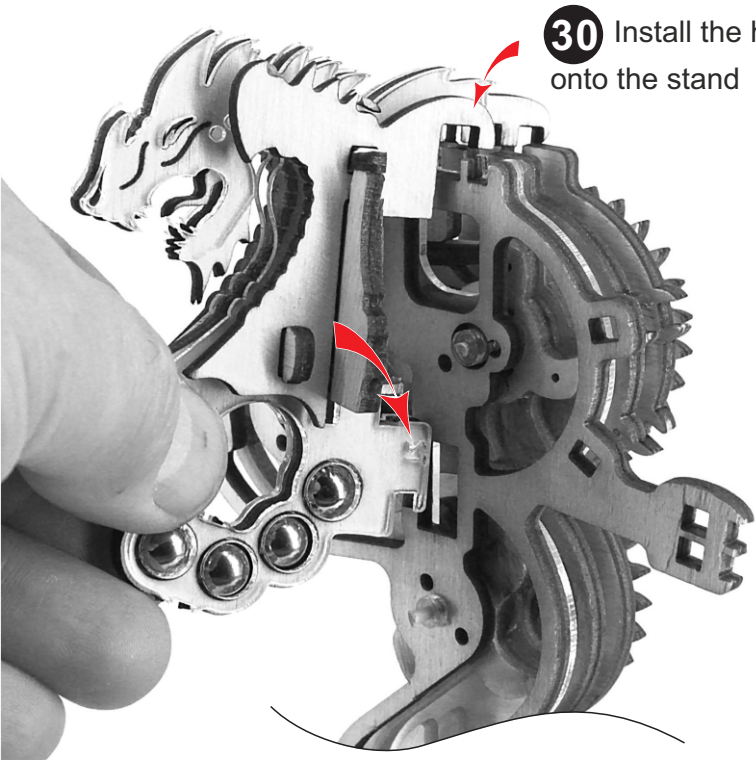

**30** Install the head and the switch onto the stand

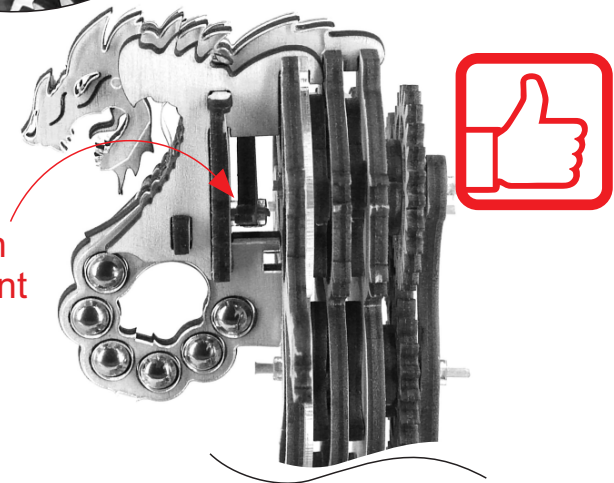
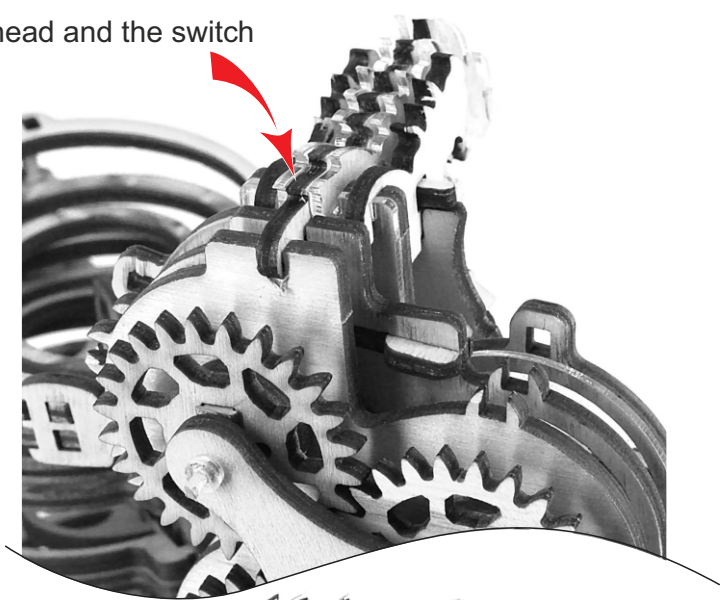

**!** Check the switch for free movement

**31** Join the tracks to the base, then fix them with C11

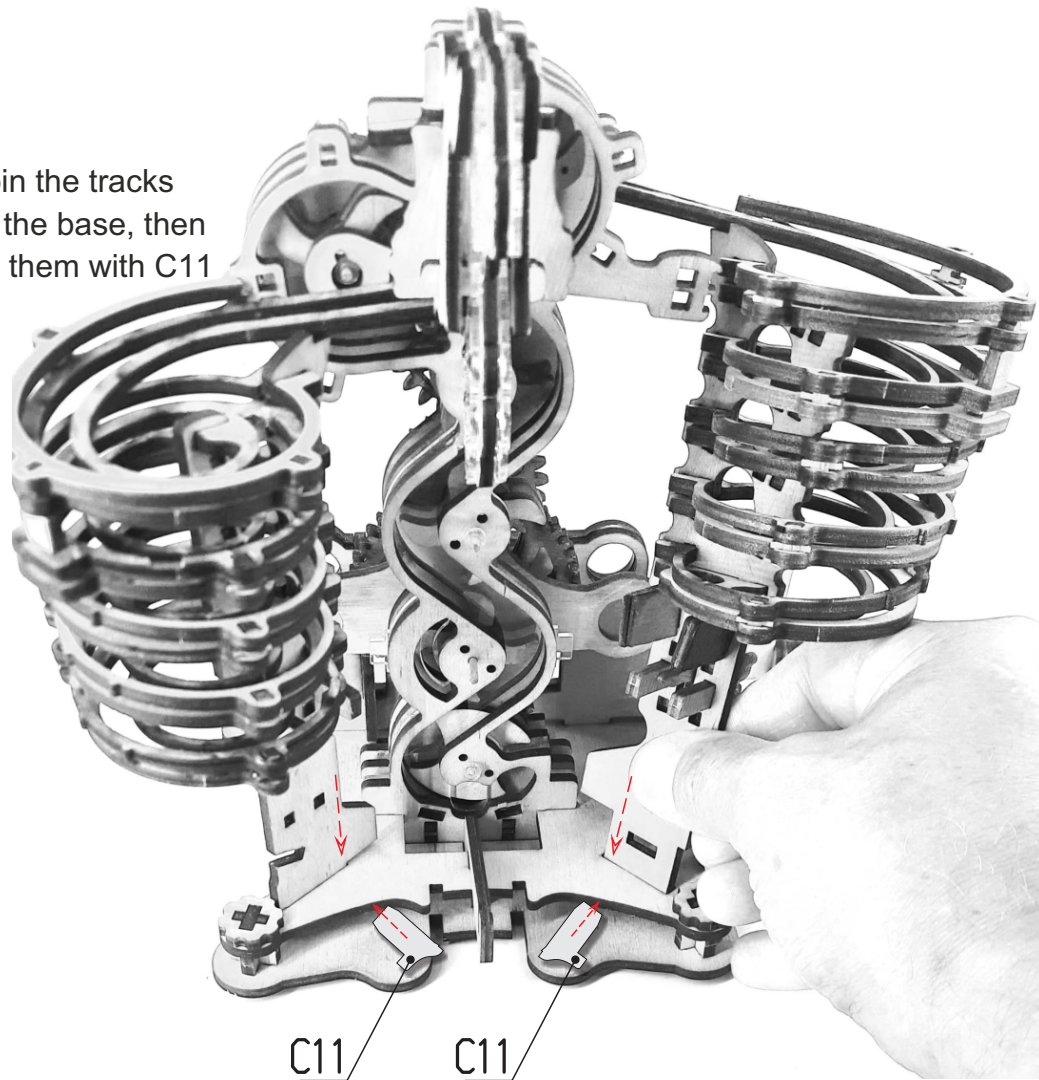

C11

C11

**32** Join the left track to the head

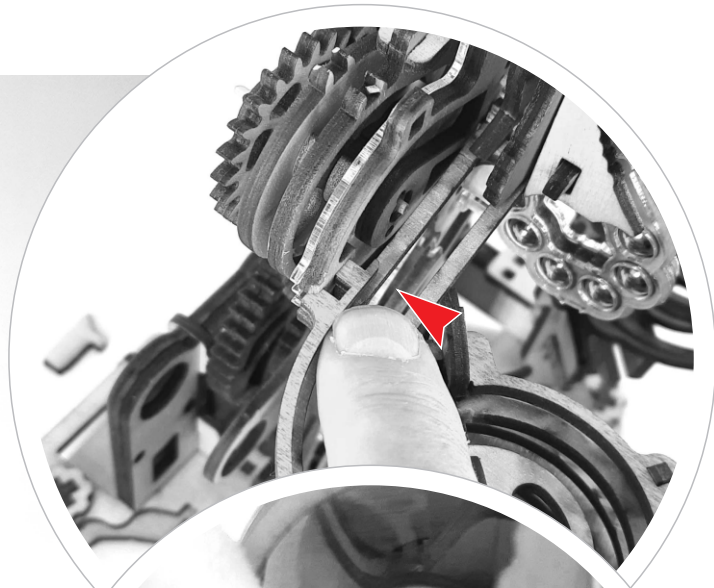
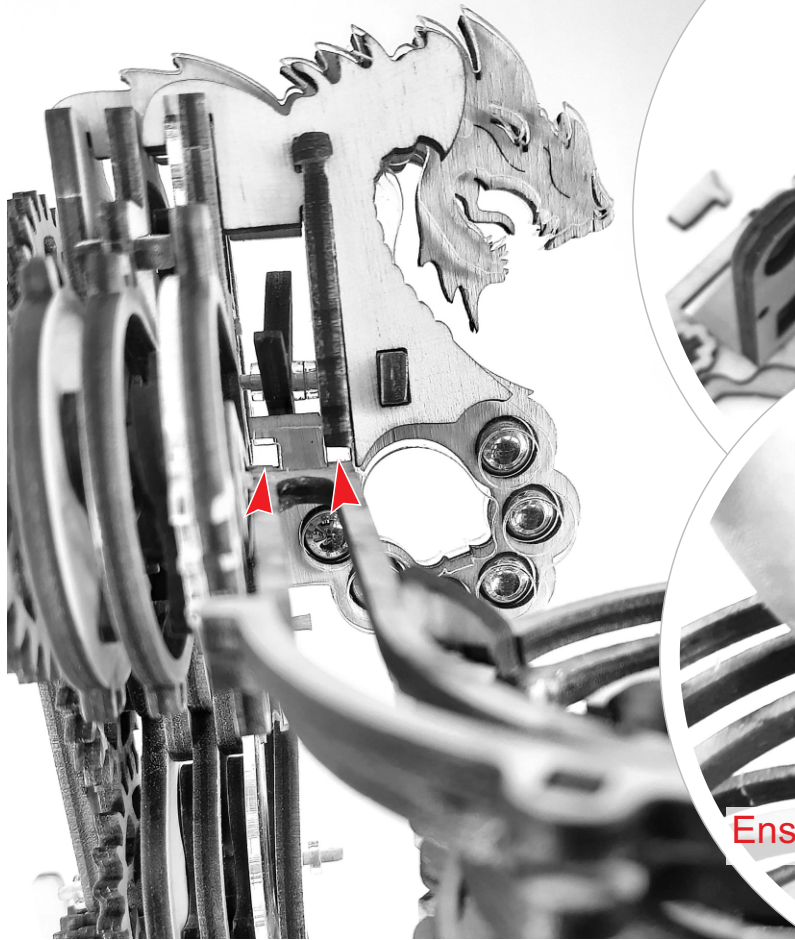

Ensure the tracks are supported here



**33** Join the right track to the head

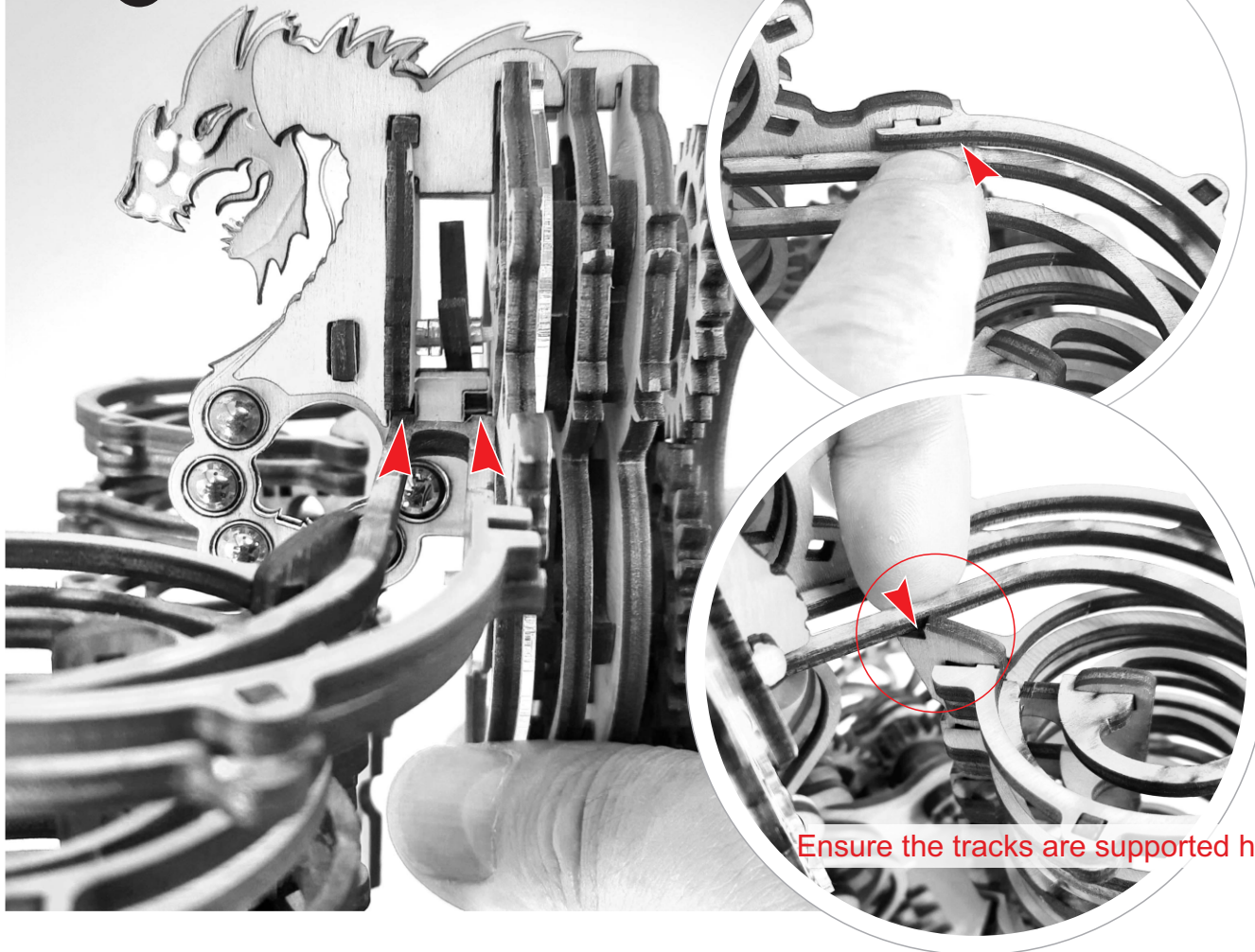

Ensure the tracks are supported here

**34** Assemble and install the gutter

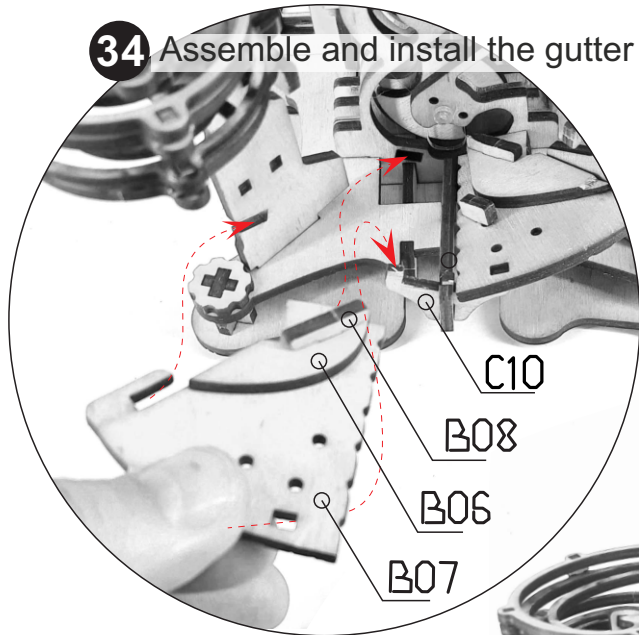

**35**

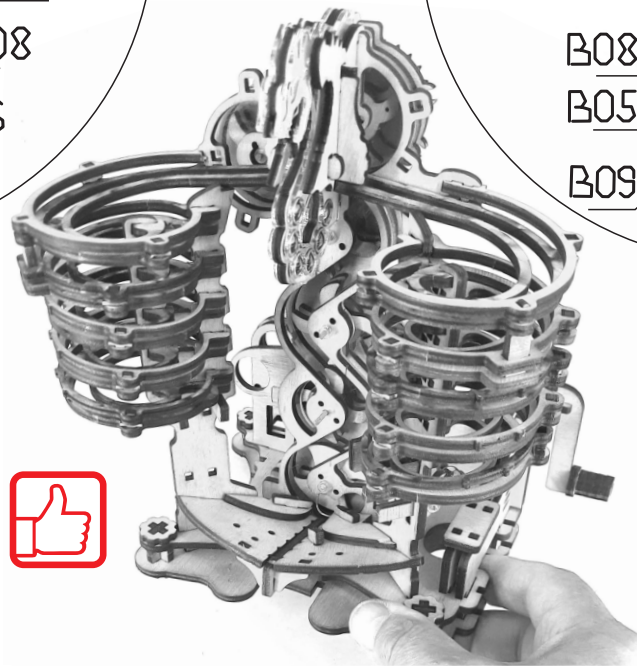
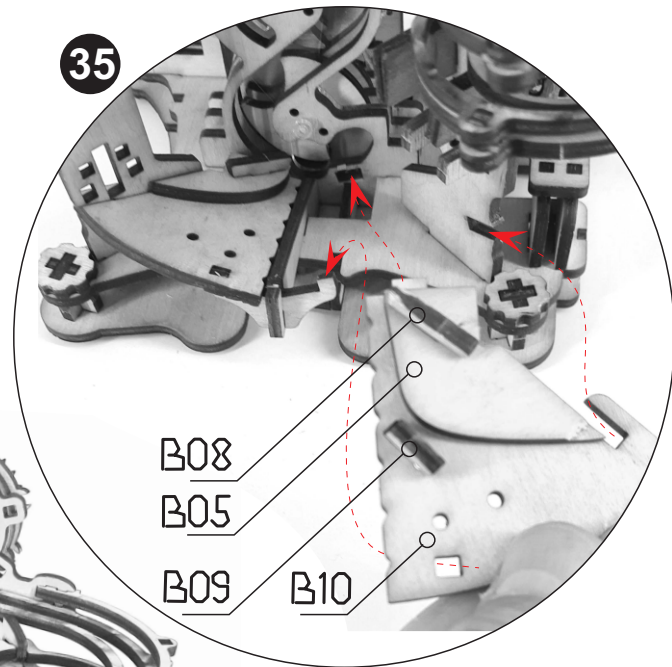

**36** Install 2 x D09 lower tracks



**37**

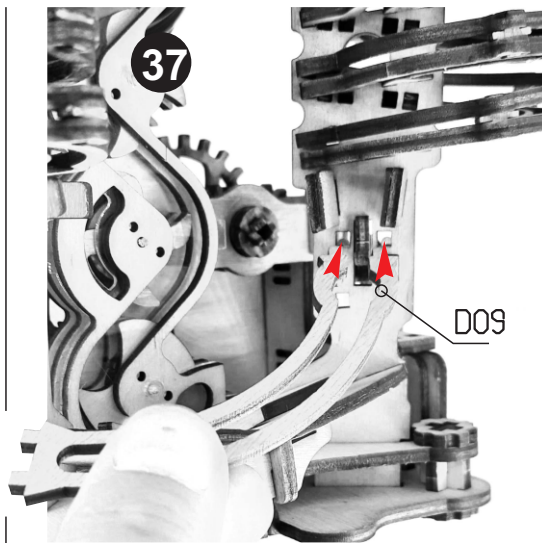

**38**

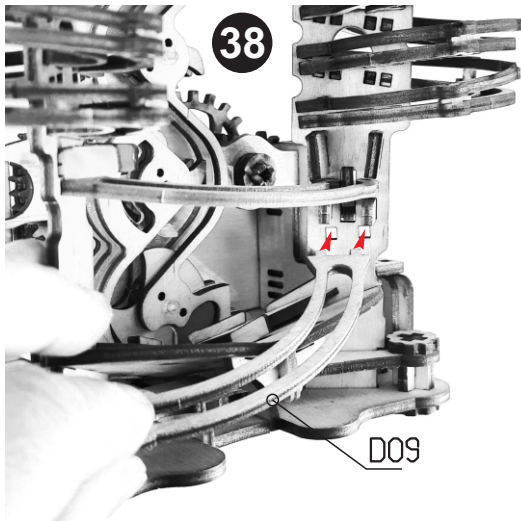

**39**

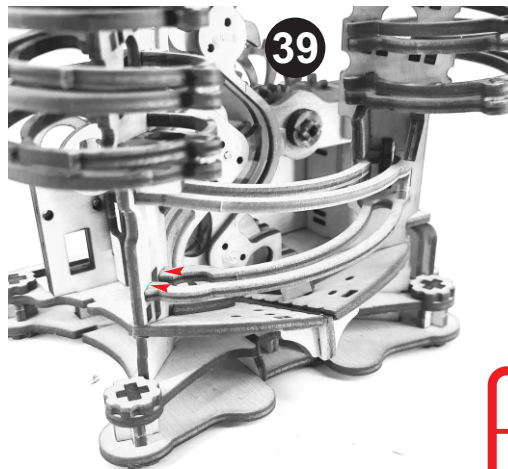

**40** Assemble the wings

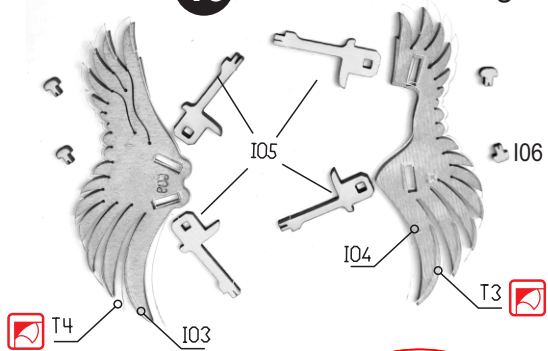

**41**

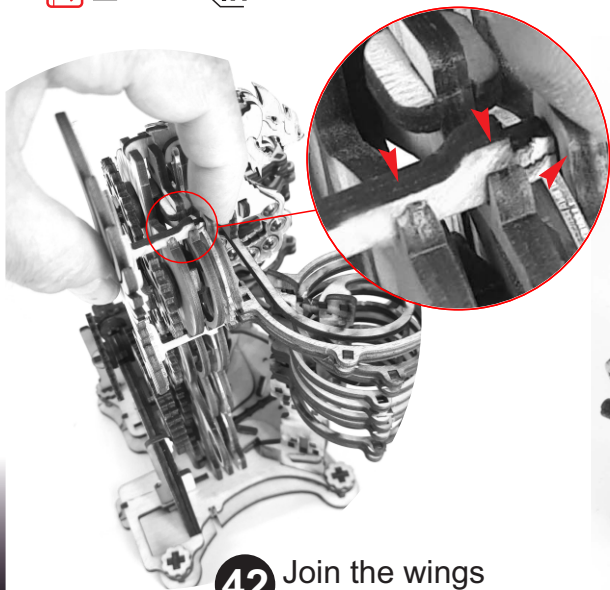
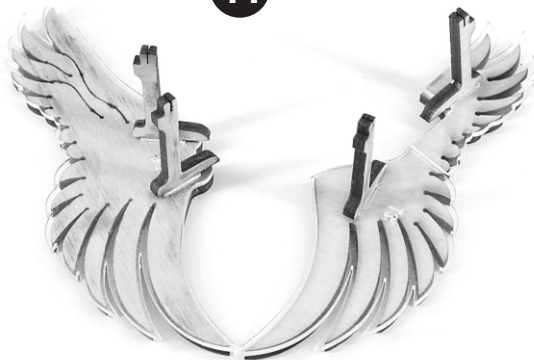

**42** Join the wings to the stand

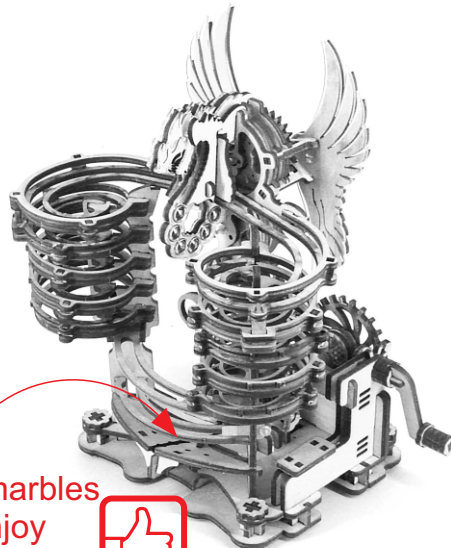
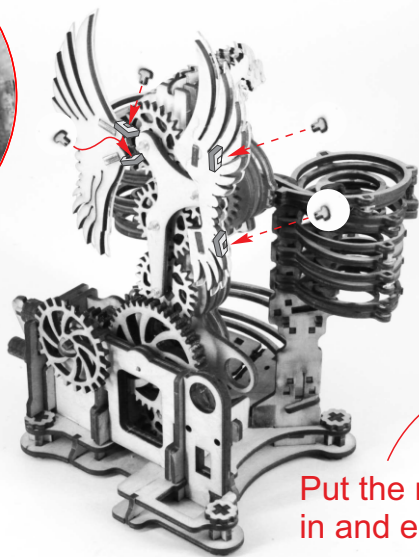

Put the marbles in and enjoy



Congratulations!



# CLUEBOX

More puzzles and games  
by iDventure  
[www.idventure-shop.de](http://www.idventure-shop.de)



CLUEBOX is an interactive box with various puzzles that you have to solve to open the box.

It's an Escape Room game in a handy format!



The Trial of Camelot



Cambridge Labyrinth



Davy Jones' Locker



Captain Nemo's Nautilus



Schrödinger's Cat



Gift  
Puzzle  
BOX

### Birthday Cake

- Mechanical wooden gift box
- Secret vault inside
- Solve 3 puzzles to open
- Age is customizable

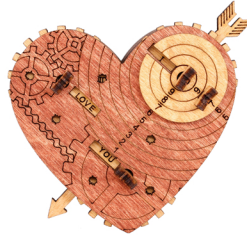

Gift  
Puzzle  
BOX

### Tin Woodman's Heart

- Mechanical wooden gift box
- Secret vault inside
- Customizable 3-word code lock
- Over 50 possible combinations



Gift  
Puzzle  
BOX

### Kryptos

- Wooden construction kit
- Secret vault inside
- 6-letter code lock



Gift  
Puzzle  
BOX

### New Year Hut

- Wooden construction kit
- Secret vault inside
- Solve a puzzle to open
- Christmas tree decoration



LIVE  
MISSION  
GAME

### The Heist

- Cooperative tabletop game
- Bank robbery in real time
- App integration
- 1-5 players



### Greeting Escape Cards

- Puzzle game and greeting card combined
- The solution of each puzzle is a clue for the next one

